

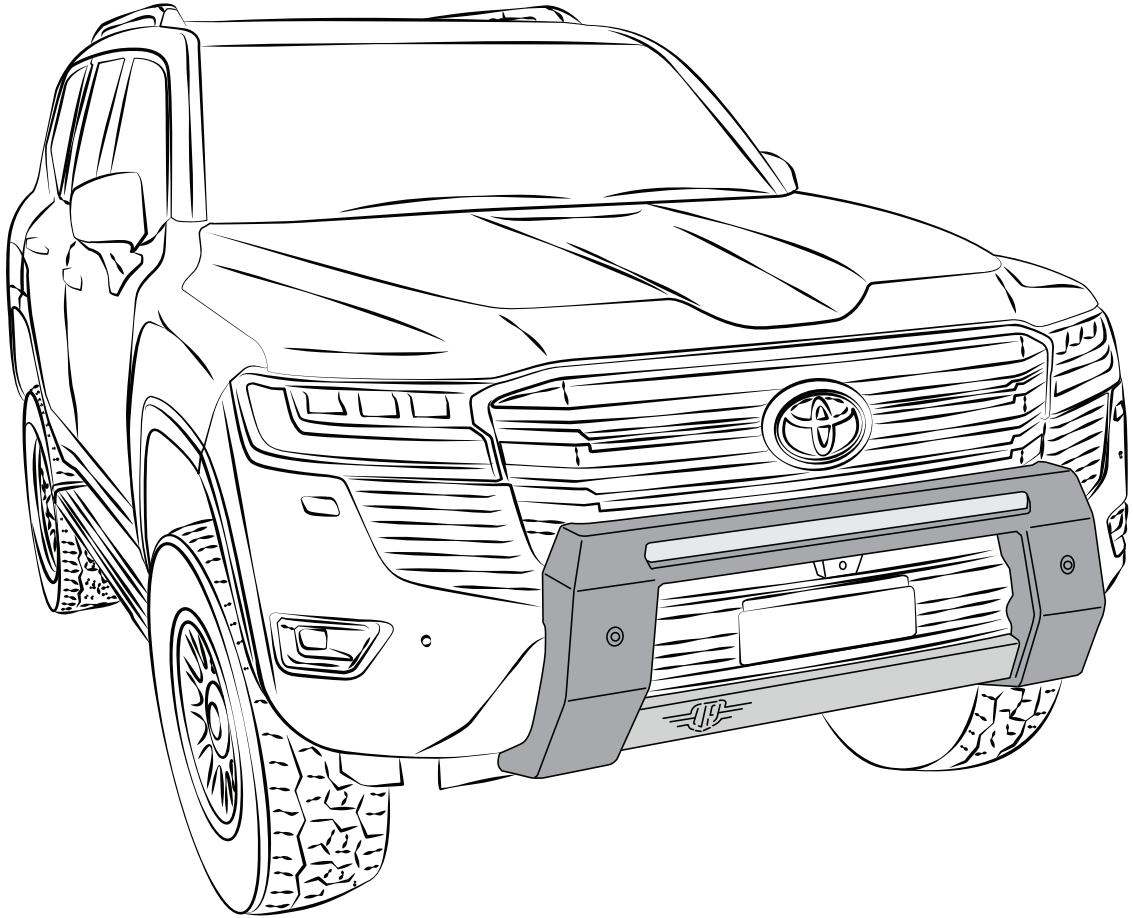

# FITTING INSTRUCTIONS



## NUDGE BAR

TO SUIT  
LC300 SAHARA,  
VX, GX & GXL

**WARNING!**

When installed in accordance with these instructions, the VFPS (Vehicle Frontal Protection System) will not effect the operation of the vehicle's SRS airbag.

**NOTE**

- Do not attach the VFPS to the vehicle using anchorages not intended for this purpose (e.g. engine mounting bolts)
- Do not use this product for any vehicle make or model, other than those specified by Ultimate9®
- Do not remove the identification plaque or label from the VFPS.
- Do not modify the structure of the VFPS in any way
- The installation of this product may require the use of additional materials, specialised tools, and/or techniques. Please read and understand the instructions thoroughly before commencing any fitment.

**THE FOLLOWING SYMBOLS ARE USED IN THESE FITTING INSTRUCTIONS**

Warning - Read the included note carefully as damage may result



Danger - Must read before continuing as injury may result



Eye Protection - The following step requires the use of protective eye wear



Hearing Protection - The following step requires the use of protective ear muffs or plugs



Tip - Follow to make fitting easier or to save time



Special tools required

**GET THE LATEST INSTRUCTION UPDATE**

Go to [www.ultimate9.co](http://www.ultimate9.co) for the latest downloadable PDF version of this instruction booklet.



## FITTING INSTRUCTIONS

NUDGE BAR TO SUIT

TOYOTA LC300

SAHARA, VX, GX & GXL

### GENERAL TOOLS REQUIRED FOR FITMENT

Metric Socket Set	Metric Ring & Open End Spanners
Phillips And Flat Blade Screw Drivers	Sharp Knife
Drill Bit Set - Metric	Tin Snips Or Hacksaw
File Or Sandpaper	

### SPECIAL TOOLS REQUIRED FOR FITMENT

Torque Wrench 3/8" Drive	Torque Wrench 1/2" Drive
Step Drill - 6-20mm (if using round switch)	Plastic Trim/Clip Removal Tools
Wire Strippers	UTILUX #124 Crimp Tool
T25 Torx bit and driver	

### GENERAL TORQUE SPECIFICATIONS

**Note: In absence of notation or manufacturers spec use the below as a guide**

SIZE	TORQUE (Nm)	TORQUE (lb/ft)
M6	9	7
M8	22	16
M10	44	32
M12	77	57

### GENERAL CARE & MAINTENANCE

Ultimate9 Nudge Bars are finished in durable powder coatings that are best maintained by regular washing with automotive grade detergents. The surface should be protected by polishing with automotive grade waxes at no more than 6 month intervals to retain its original finish.

All fasteners should be checked for integrity at normal vehicle service intervals to ensure continued compliance with SRS airbag operation.



# FITTING INSTRUCTIONS

NUDGE BAR TO SUIT

TOYOTA LC300

SAHARA, VX, GX & GXL

APPLICATION	QTY	PART N/O.	DESCRIPTION
Chassis mounts to chassis	1	700-0038R	ASSEMBLY - WELDED CHASSIS MOUNT RH
	1	700-0038L	ASSEMBLY - WELDED CHASSIS MOUNT LH
	2	603-0004	WASHER FLAT-M12 X 24 X 1.6
	2	603-0009	WASHER SPRING-M12
	2	601-0010	BOLT HEX HEAD-M12 X 1.25 X 30 GRADE 8.8
Light bar to nudge bar	1	300-0044R	BRACKET - LIGHT MOUNT RH
	1	300-0044L	BRACKET - LIGHT MOUNT LH
	1	ULTLED30C	LED LIGHT BAR 30INCH COMBO
Wiring of PDC sensors	2	ULTELE004	PDC SENSOR EXTENSION HARNESS 500MM
	2	500-0003	CAP-PLASTIC HOLE PLUG 18MM
	2	410-0002	BUSH-SENSOR HOLDER
Nudge bar to chassis mounts	1	700-0025	ASSEMBLY WELDED - NUDGE BAR
	4	601-0001	BOLT HEX HEAD-M10 X 30 GRADE 8.8
	8	603-0002	WASHER FLAT-M10 X 21 X 1.6
	4	602-0002	NUT NYLOC-M10
Camera mount to nudge bar	1	300-0077	BRACKET-CAMERA MOUNT
	1	300-0076	BRACKET-CAMERA MOUNT
	2	603-0003	WASHER FLAT SS-M6 X 12.5 X 1.2
	2	601-0004	BUTTON HEAD CAP SCREW-M6 X 16
	2	602-0003	NUT CAGED-M6 2.6 - 3.5
Centre pan to nudge bar	1	300-0080	PANEL-CENTER FOLDED
	4	603-0003	WASHER FLAT SS-M6 X 12.5 X 1.2
	4	601-0004	BUTTON HEAD CAP SCREW-M6 X 16
	4	602-0003	NUT CAGED-M6 2.6 - 3.5
Wiring of light bar	1		CANBUS HARNESS
	1		RELAY HARNESS
	20	606-0001	CABLE TIE - 280MM X 4.8MM
	10	606-0002	CABLE TIE - 203MM X 2.5MM
	1	300-0029	BRACKET-RELAY MOUNT SINGLE
	1	601-0008	BOLT-M5 X 12
	1	603-0007	WASHER FLAT-M5
	1	602-0008	NUT NYLOC-M5

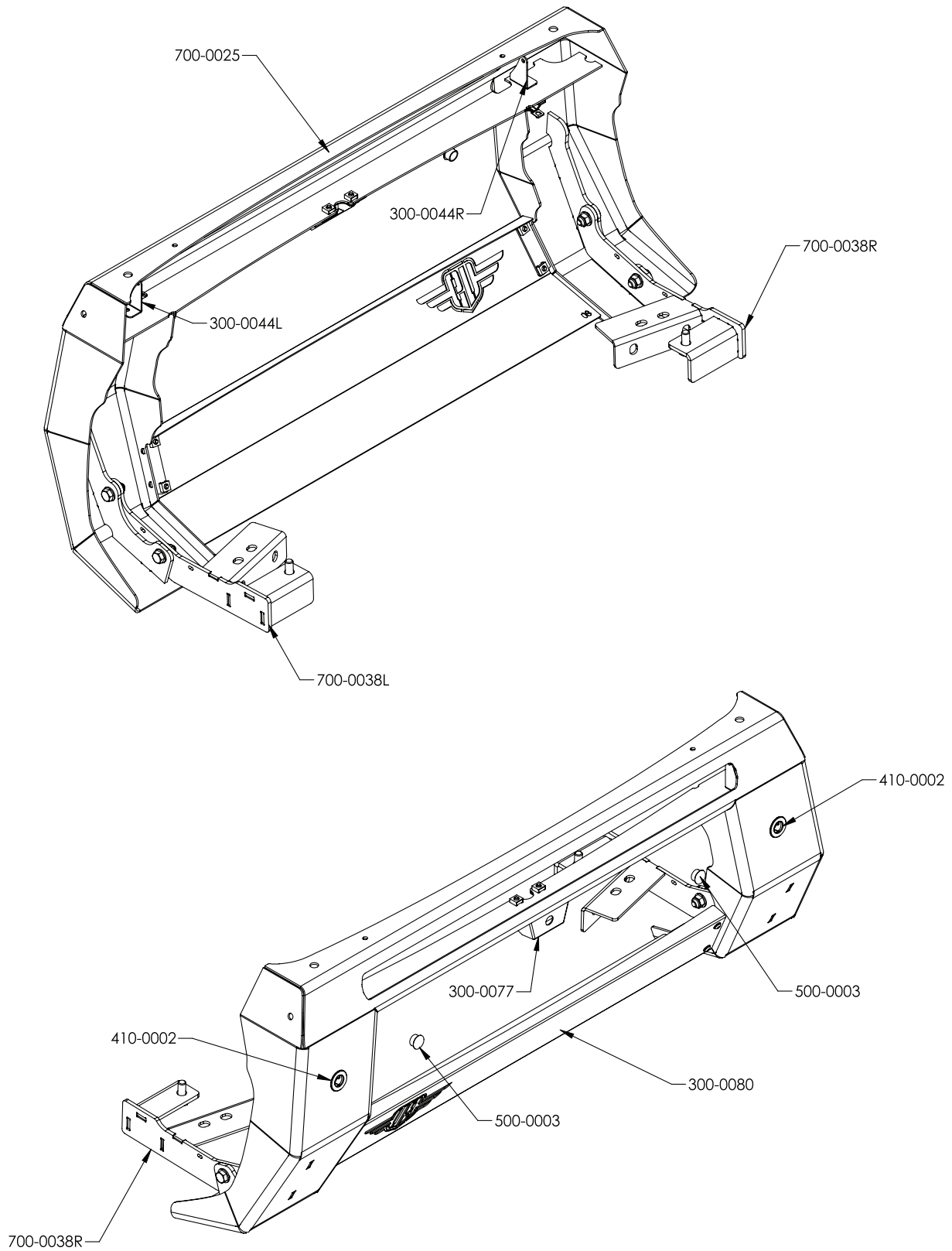
**FITTING INSTRUCTIONS****NUDGE BAR TO SUIT  
TOYOTA LC300  
SAHARA, VX, GX & GXL**



## FITTING INSTRUCTIONS

NUDGE BAR TO SUIT

TOYOTA LC300

SAHARA, VX, GX & GXL

1

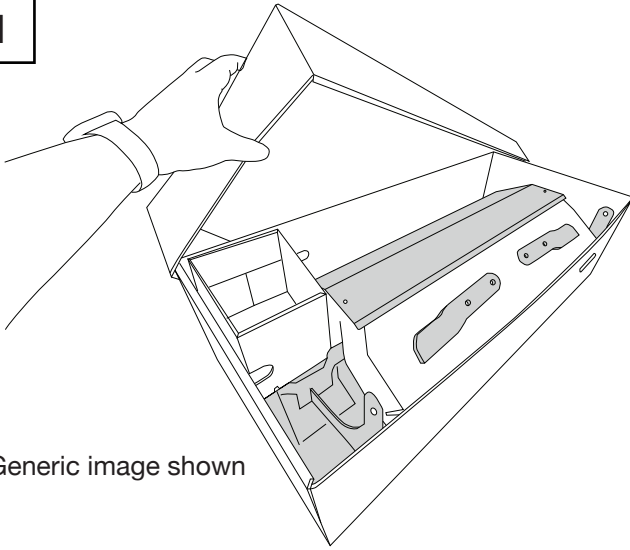

Generic image shown

Remove the nudge bar from its packaging.



NOTE: The nudge bar is wrapped in protective tape to prevent damage during transport. Carefully remove each component and the cardboard inserts. If using a knife to open packaging, take care as damage to the powder coated finish may result.

2

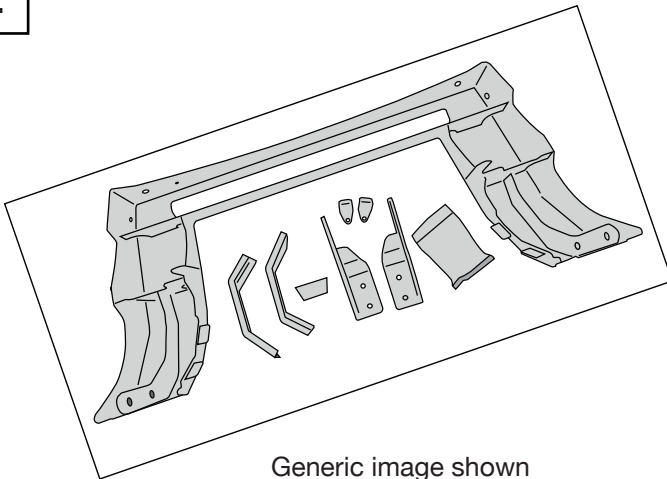

Generic image shown

Prepare the bar for fitting.

Lay the bar down on a protective surface such as cardboard or a blanket, preferably at bench height.

Unpack the fitting kit and check that all the components are complete as per the parts list.

3

NO IMAGE

Install the wiring harness for the light bar.

There are two harnesses supplied for operation of the light bar.

1. The relay harness - for fitment under the bonnet. This powers the light bar from the battery.
2. The Canbus harness - for fitment under the dash board. This provides a switch and high beam trigger wire for activation of the light bar

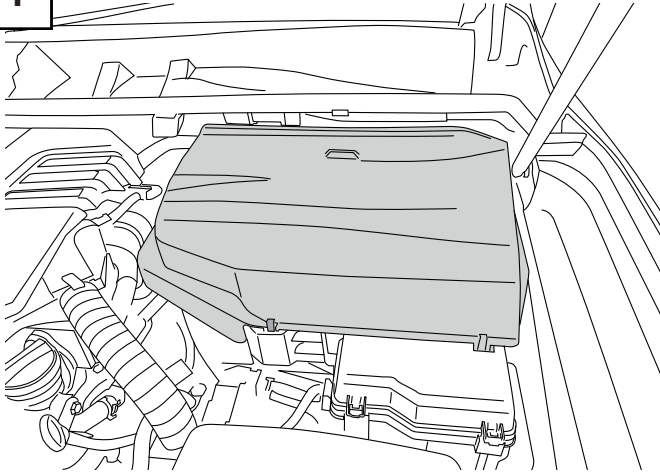
**4****Remove the battery.**

Remove the battery cover as shown.

Remove the red cover from the positive battery terminal. (not shown)

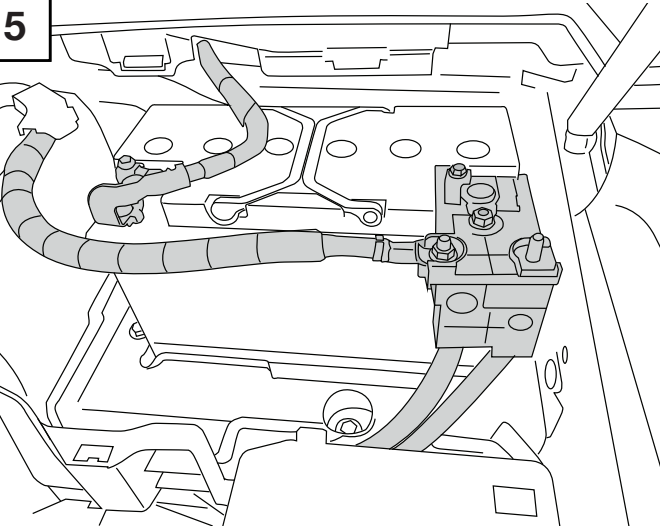
**5**

Remove the negative and positive battery cables from the battery terminals.

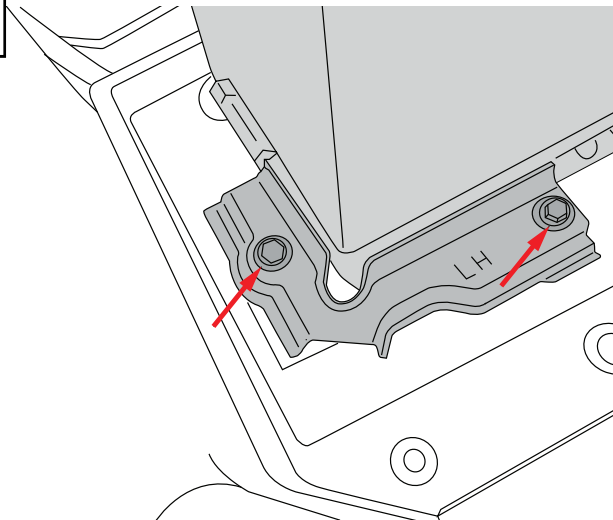
**6**

Remove the battery hold down clamp (located on the front inboard side of the battery) by removing the two M8 bolts as shown.

Carefully lift the battery out of the vehicle.



Take care to prevent electrical shorts from touching components when lifting the battery.

## FITTING INSTRUCTIONS

NUDGE BAR TO SUIT

**TOYOTA LC300**

**SAHARA, VX, GX & GXL**

7

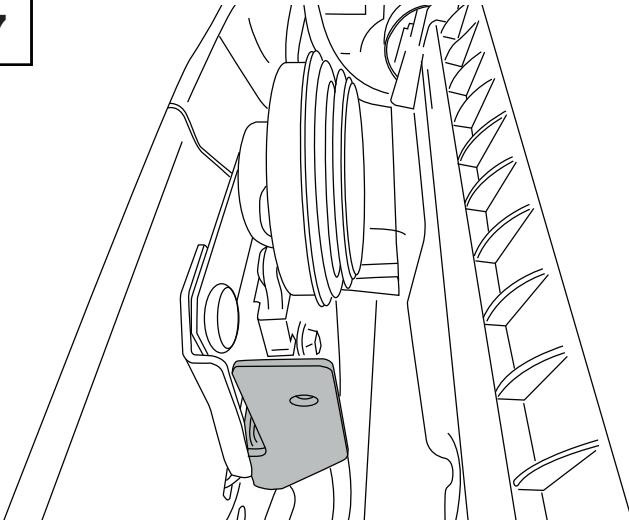

### Install the relay harness.

Lay the relay harness out in front of the battery along the inner guard.

Mount the relay bracket to the mounting bracket of the horn assembly on the inner guard as shown.

Mount the relay to the relay bracket using M5 hardware.

8

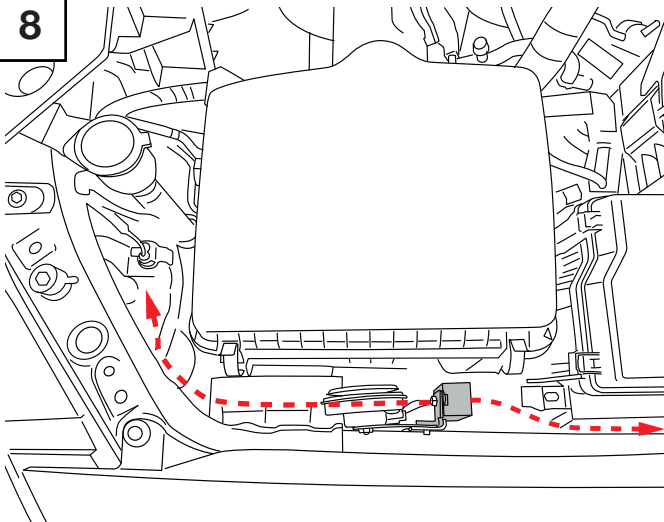

Route the two cables with DT connectors from the relay, following the inner guard to behind the headlamp assembly and down to the chassis rail.

Allow them to hang for connection to the light bar/s in step 66.

Note: the second connector is for the addition of a second light bar to the nudge bar if required.

Route the pink wire and positive and negative cables along the inner guard to the battery tray. Pass the pink wire around or under the tray to the main wiring harness grommet in the firewall and secure all cables neatly with cable ties so as not to move or rub on other components.

9

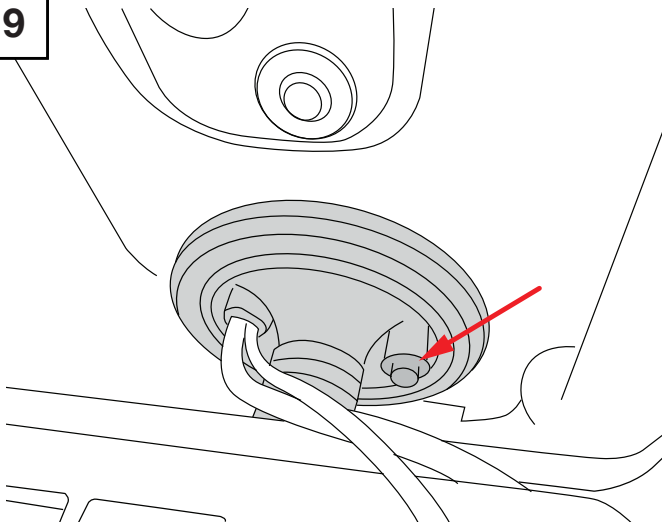

The harness grommet has two nipples, one on either side. Using the right hand nipple, pierce the end with a blade or side cutters.

Pass the PINK high beam wire from the relay harness through the nipple/grommet and into the cabin.



Use plastic tubing as a pull through and lubricant such as silicon spray to help feed the cable through the grommet.

Note: do not use solid wire such as a coat hanger as damage to other wiring may result.

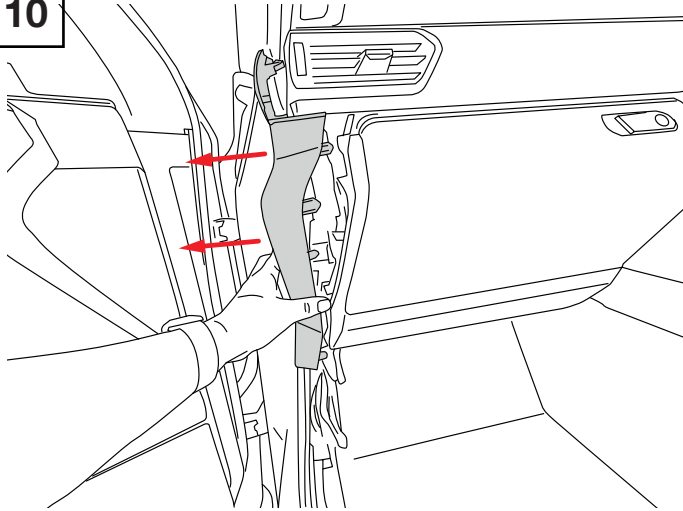
**10****Remove plastic trims.**

Remove the plastic trim on the LHS dash as shown.

The trims are held in place with plastic clips that can be levered with a trim removal tool.

Pull the trim in the direction of the arrows to disengage clips.

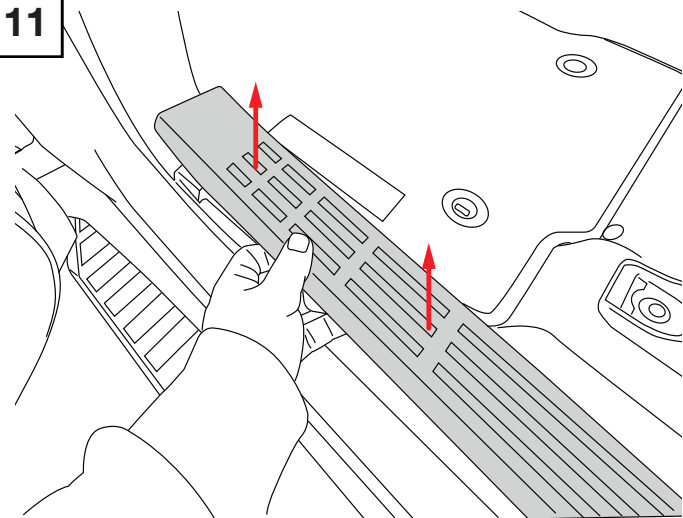
**11****Remove the plastic door sill scuff panel.**

Using a plastic trim removal tool, insert between the sill and the scuff panel as shown to disengage the clips. Lift upwards to detach.

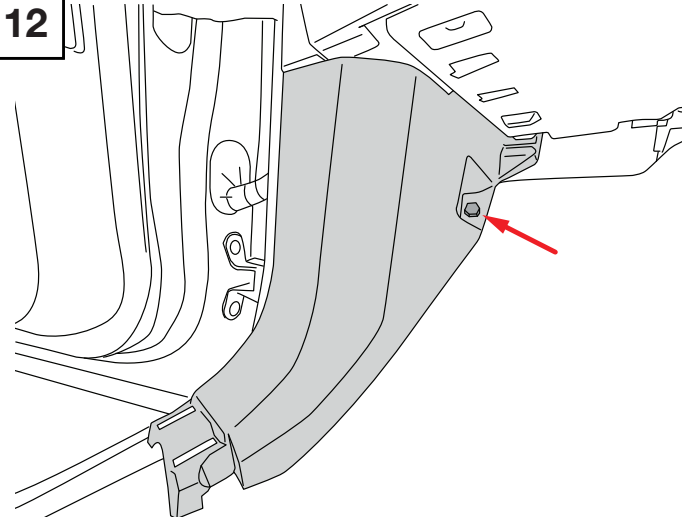
**12****Remove the plastic nut that holds the kick panel in place.**

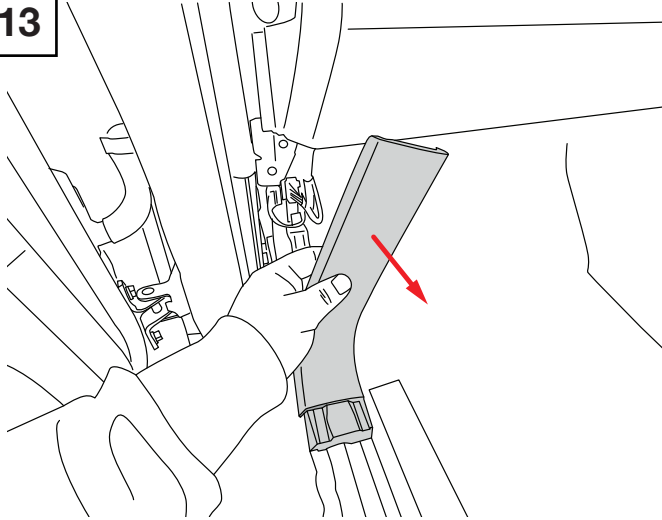
**13**

Pull the kick panel as shown to disengage the trim clips and lift up and out.

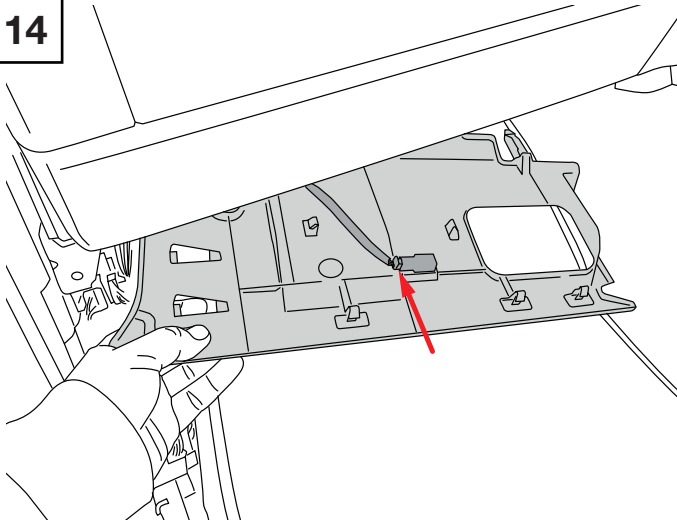
**14**

Remove the under dash trim panel releasing the clips on the front edge and pulling downwards.

Disengage the electrical plug and remove the panel.

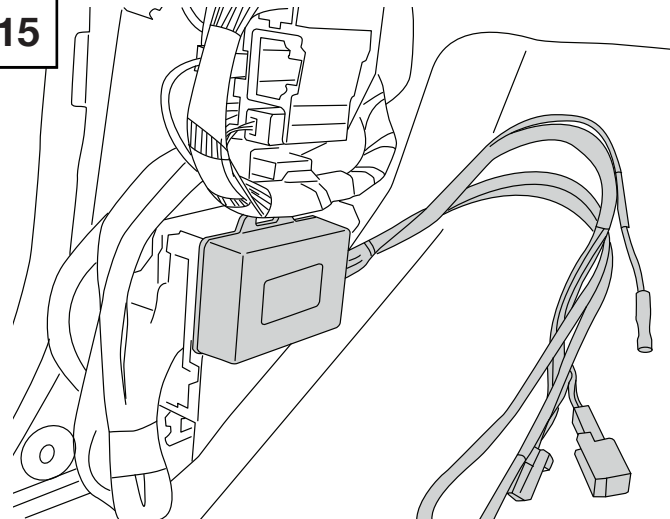
**15**

**Attach the CANBUS module.**

Peel the backing from the double sided tape on the back of the CANBUS module and attach it to the flat surface of one of the other modules in the kick panel under the dash as shown.

Do not refit the trim panels until step 29.

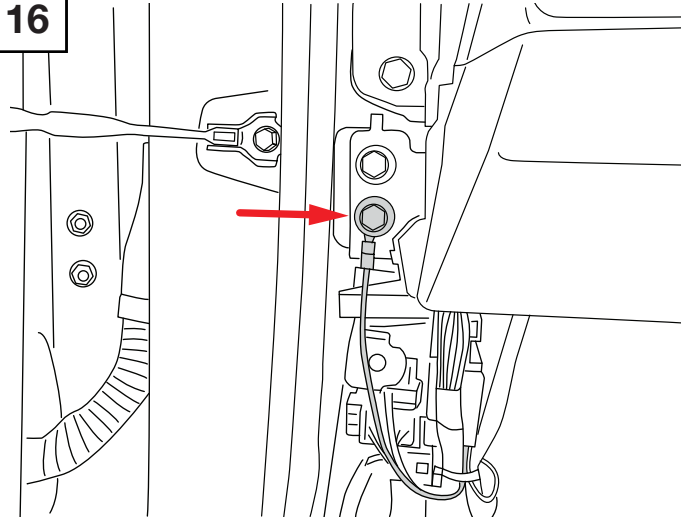
**16****Attach the CANBUS earth cable.**

On the side of the dash, adjacent to the door hinge is a small bracket with two 6mm bolts. Remove the lower 6mm bolt and attach the black earth cable as shown.

Torque bolt to: 9Nm (7lb/in)

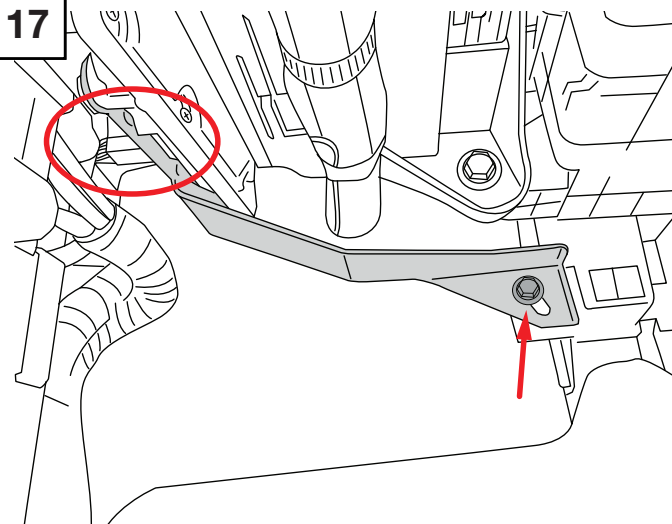
**17****Attach the CANBUS red power cable.**

Below the glove box and above the kick panel is a steel bracket that retains one of the electrical modules (note not fitted on all models). Reach in behind this bracket and up to the area marked by the red circle to detach a white rectangular plug. The bracket has sharp edges so remove the bolt as indicated by the arrow to gain easier access, or cover the bracket edges with masking tape to prevent injury.

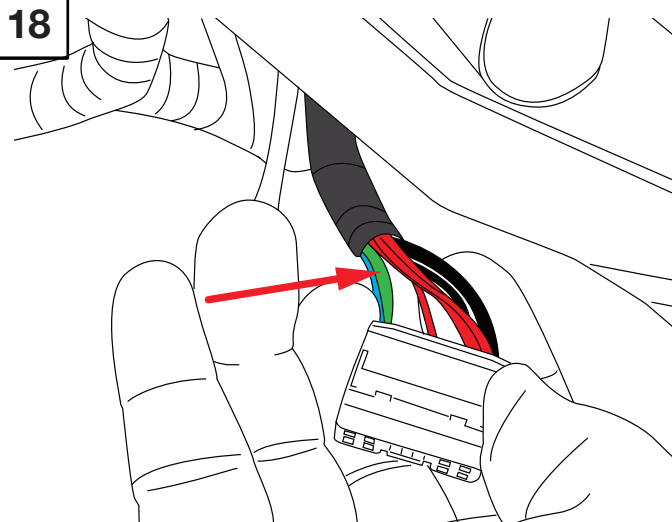
**18**

Find the green wire in the back of the connector as shown. Crimp the positive red wire from the CANBUS module to it using the white crimp connector (pre fitted to the positive (red) wire).

**FITTING INSTRUCTIONS**

NUDGE BAR TO SUIT

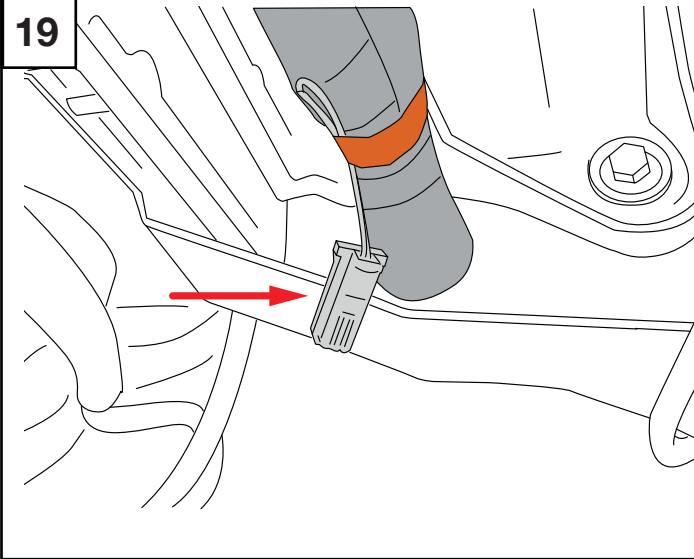
**TOYOTA LC300**
**SAHARA, VX, GX & GXL**
**19**

**Connect the CANBUS signal wire.**

Below the glove box (above the kickpanel) is a large wiring harness. There is an unused small white two pin plug with black and white wires that is taped to the harness with dark orange coloured tape.

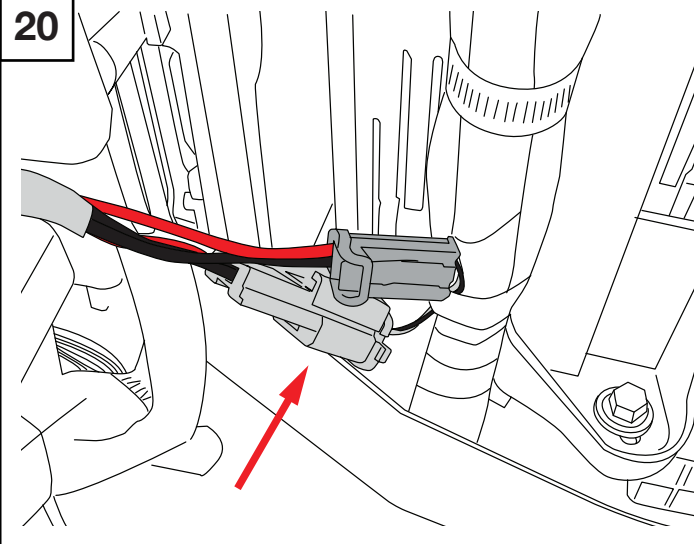
This plug provides a signal for the CANBUS module.

**20**

Attach the white male two pin plug (red and black wires) from the canbus harness to this plug.

If the two pin plug is already in use by another accessory, the CANBUS harness has a secondary two pin female plug that this can be plugged into. (shown dark grey)

Leave the PINK high beam cable loose. This will be connected in step 28.

No other wires (low beam or fog beam) are required. These can be taped or cable tied neatly out of the way.

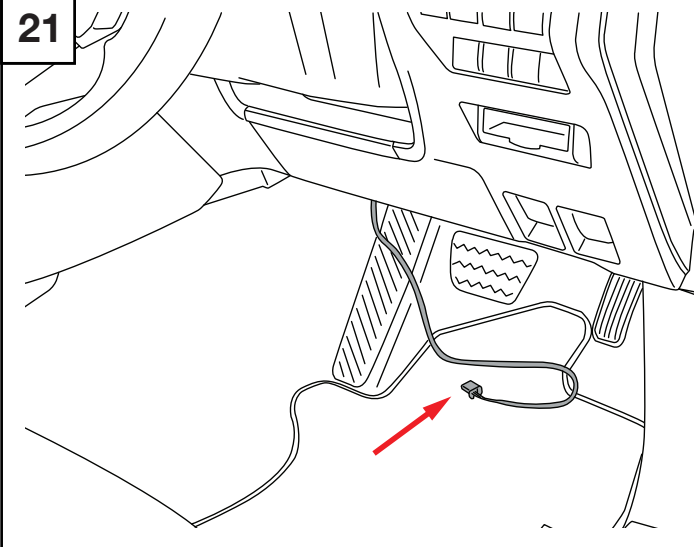
**21**

**Route the switch cable to the drivers switch panel.**

Remove the switch from the switch cable and feed the cable behind the carpet and over the transmission hump to the drivers side floor.

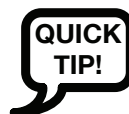
Allow the cable to rest on the floor until step 26.

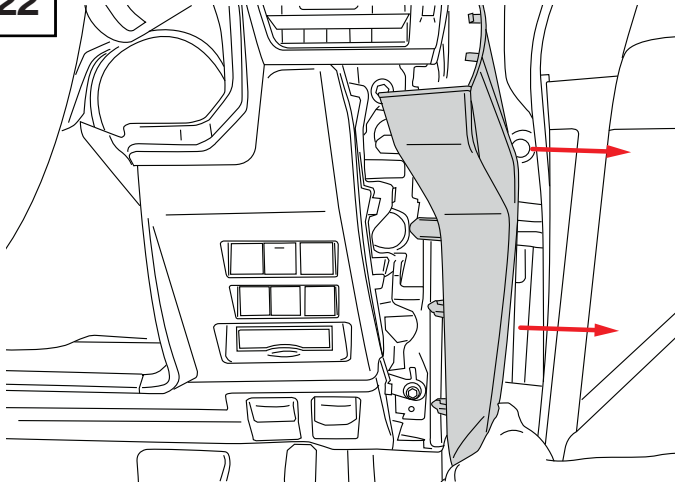

Use plastic tubing as a pull through.

**22****Remove drivers side plastic trims.**

Remove the drivers side plastic dash trim using the same method as on the LHS as shown .

The trims are held in place with plastic clips that can be levered with a trim removal tool.

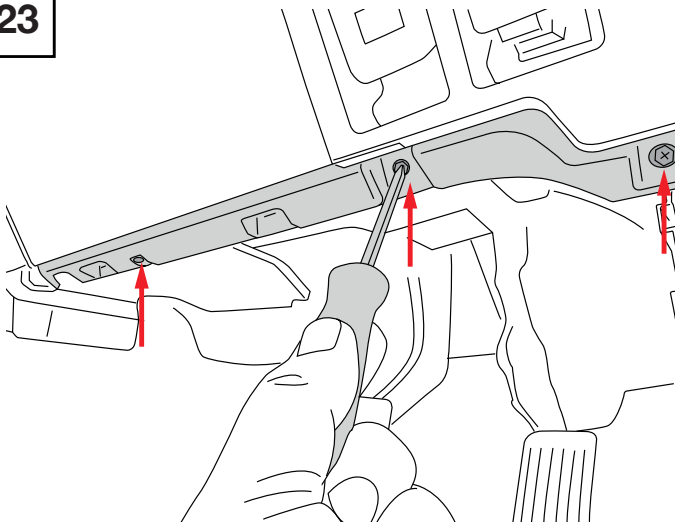
**23****Remove the under dash trim panel.**

Remove the drivers side under dash trim panel by removing the three Phillips head screws and pull downwards to disengage clips.

This will allow access to run the switch cable from the transmission tunnel to the back of the switch panel.

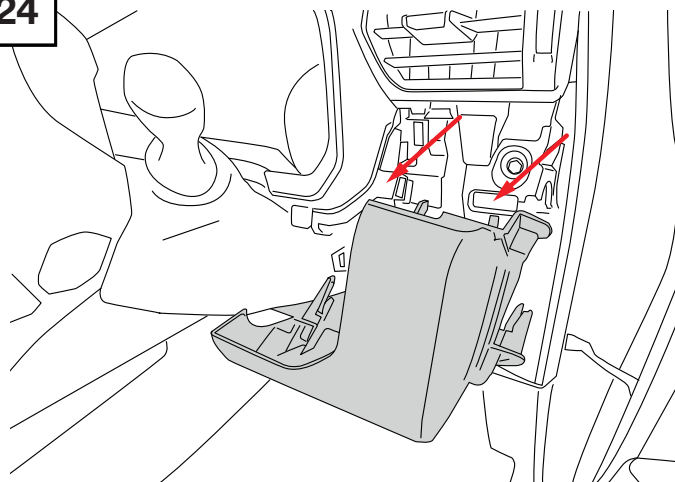
**24****Remove the switch panel.**

Gently pull on the switch panel to disengage from the dash. This allows access to the back of the switch panel.

The clips that hold it in place may need some persuasion as they can be tight. Use a plastic trim tool to pry on the clips if required.

## FITTING INSTRUCTIONS

NUDGE BAR TO SUIT

TOYOTA LC300

SAHARA, VX, GX & GXL

25

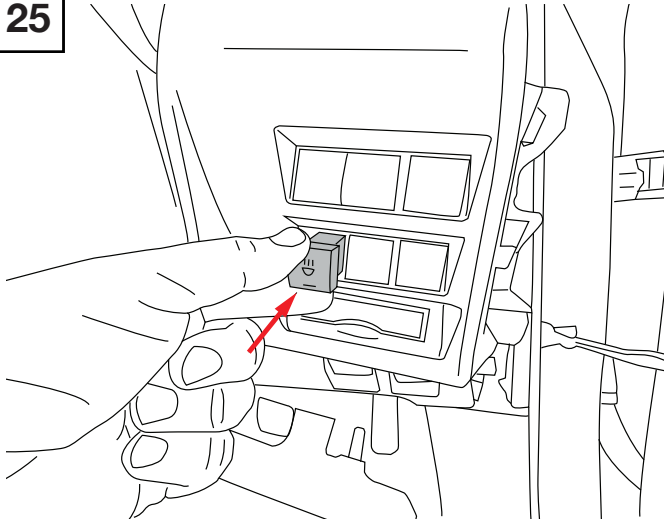

Fit the LED light bar switch.

Remove the switch blank from the switch panel by disengaging the clips on the back.

Insert the new switch into place and push in until seated.

26

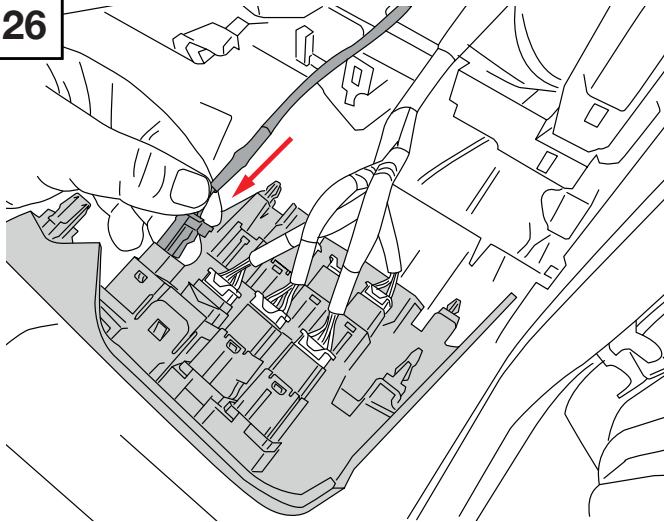

Route the switch harness from the transmission tunnel, under the dash and connect into the back of the switch.

Cable tie in place so that no cable hangs down below the dash.

27

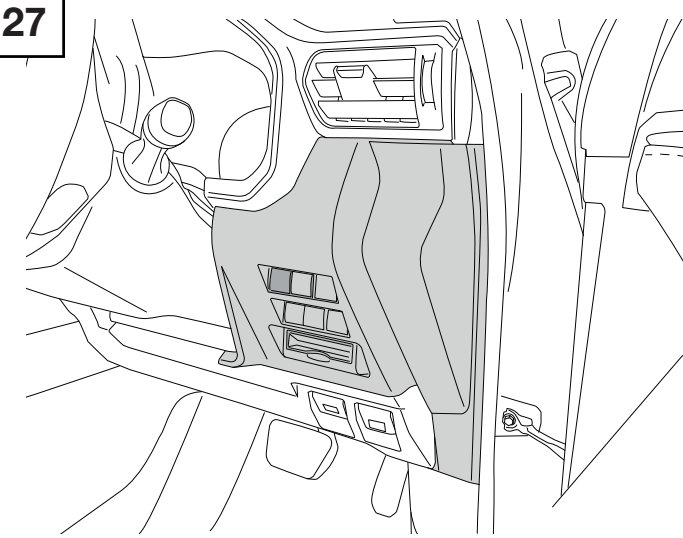

Refit the switch panel, under dash trim, and side panel.

## FITTING INSTRUCTIONS

NUDGE BAR TO SUIT

**TOYOTA LC300**

**SAHARA, VX, GX & GXL**

**28**

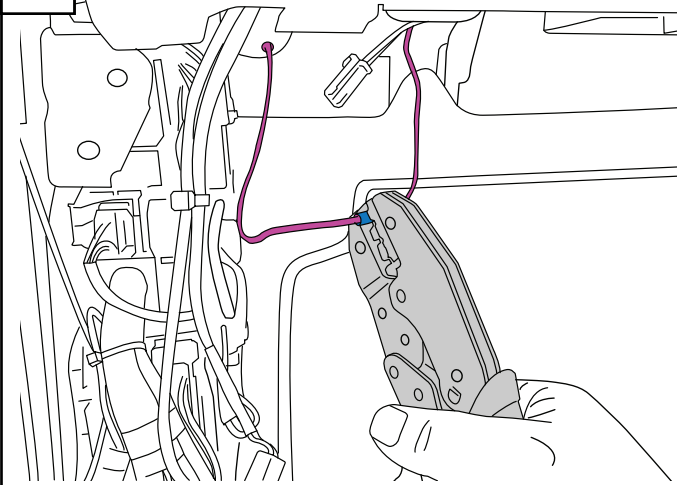

Working under the LHS dash, connect the PINK high beam wire from the Relay harness to the PINK wire on the CANBUS harness using the crimp connector.

Cable tie all loose wires so that they do not hang down from the dash to prevent damage.

**29**

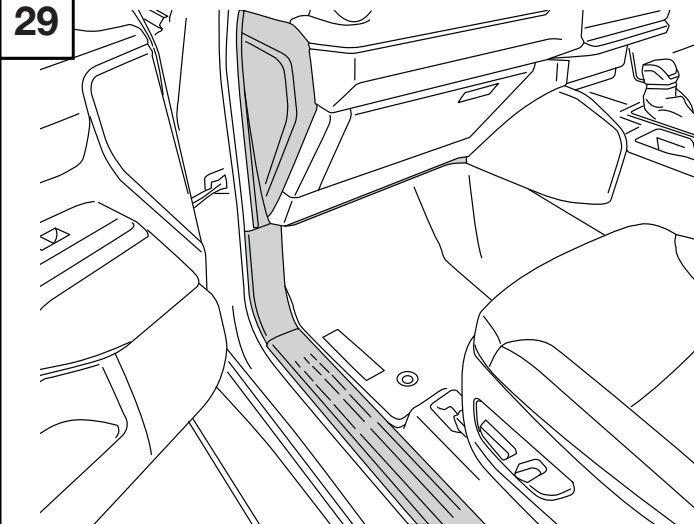

Reinstall the LHS dash side trim, under dash trim, kick panel and scuff panel ensuring all screws and retaining nut are refitted.

**30**

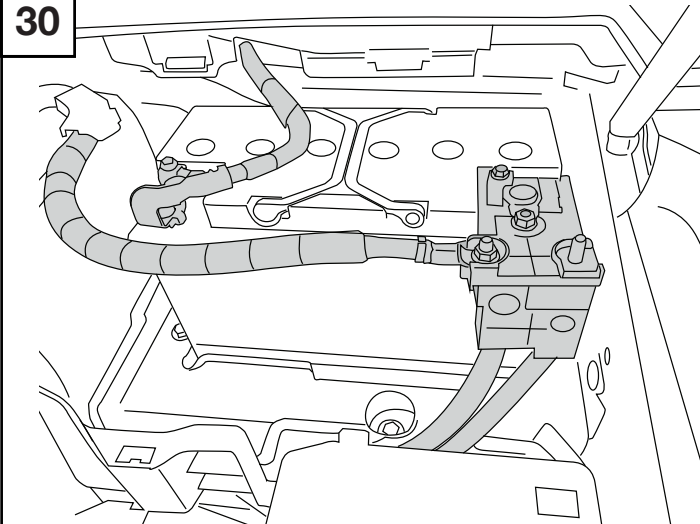

**Reinstall the battery.**

Reinstall the battery, and hold down clamp. Installation is the reverse of steps 5 & 6.



Take care to prevent electrical shorts from touching components when lifting the battery.

## FITTING INSTRUCTIONS

NUDGE BAR TO SUIT

**TOYOTA LC300**

**SAHARA, VX, GX & GXL**

**31**

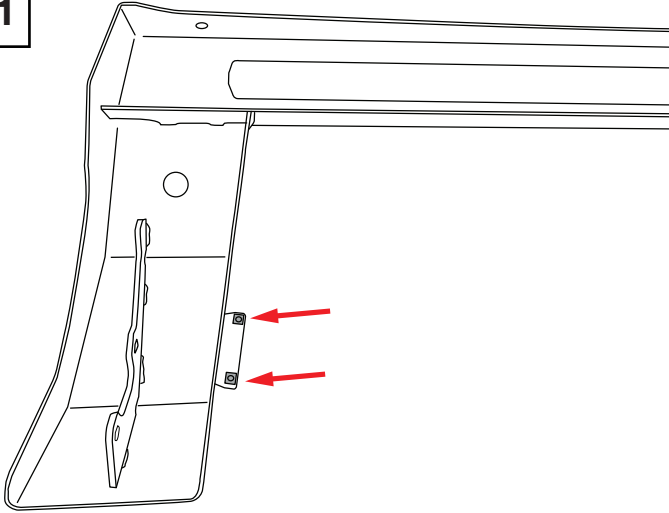

**Prepare the fasteners for attaching the centre pan.**

Place four M6 cage nuts (P/No. 602-0003) into the square holes on the two flanges as shown

Note: LHS shown, RHS same.

Ensure the nuts are fitted to the back of the flange.

**32**

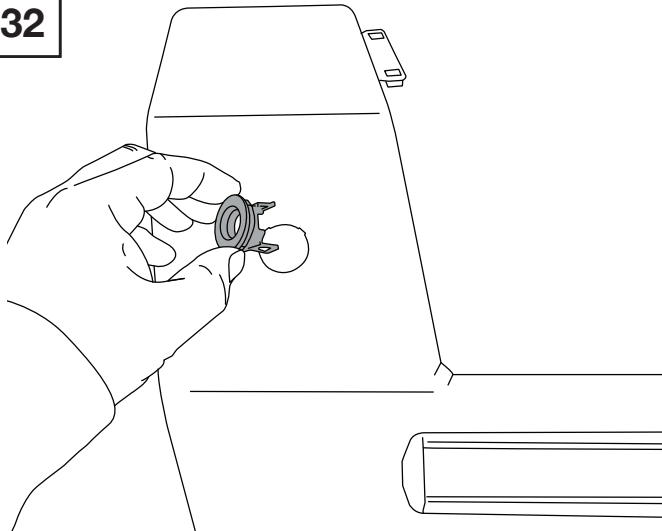

**Install the new PDC Sensor housings.**

**Note: These may have been pre-installed during manufacture.**

Push fit the new sensor holder into the round hole in the front face of the nudge bar, ensuring the retaining clips lock into place. Take note of the small locator notches to ensure they are fitted correctly.

NOTE: LHS shown, RHS same.

**33**

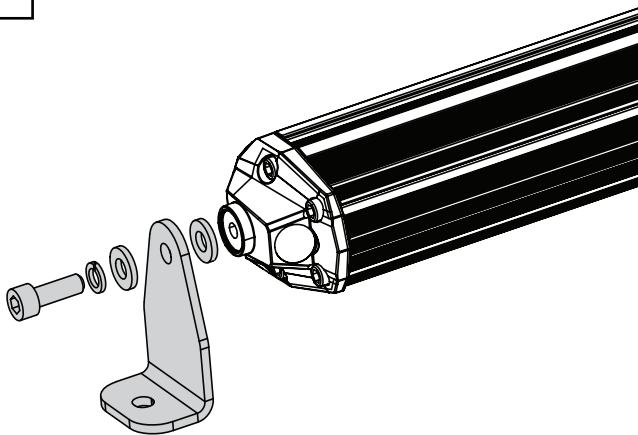

**Assemble the light bar brackets.**

Unpack the light bar from its packaging and locate the fitting kit.

Discard the mounting brackets (item 4) from the fitting kit.

Replace with the mounting brackets supplied in the nudge bar fitting kit and assemble as shown.

Note: LHS shown, RHS same.

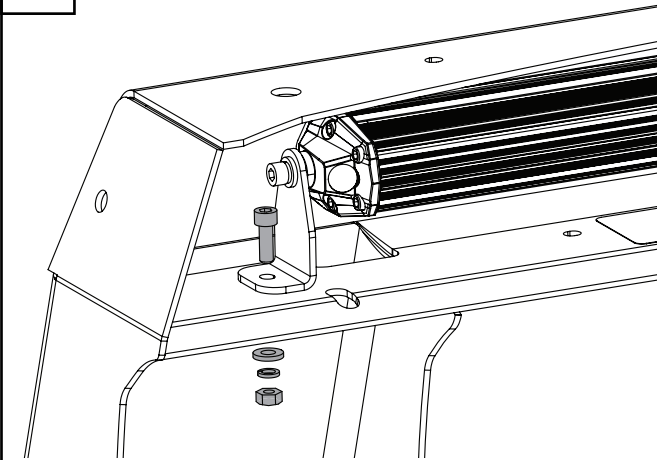
**34****Assemble light bar to nudge bar.**

Fit the light bar to the nudge bar using two M6 x 20 stainless cap screws, flat washers, spring washers and M6 stainless nuts (supplied in light bar fitting kit) as shown.

Note: LHS shown, RHS same.

Note: Fitting antennas is best performed now before fitting the nudge bar to the vehicle as access will be limited.

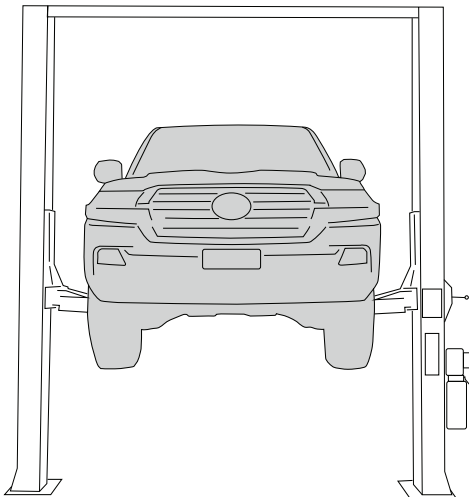
**35****Prepare the vehicle for fitment of the nudge bar.**

Note: Raising the vehicle - Always ensure the vehicle is supported by either vehicle stands or on a hoist. Consult the vehicle handbook for correct jacking locations. Never work beneath a vehicle that is unsupported or on a jack.

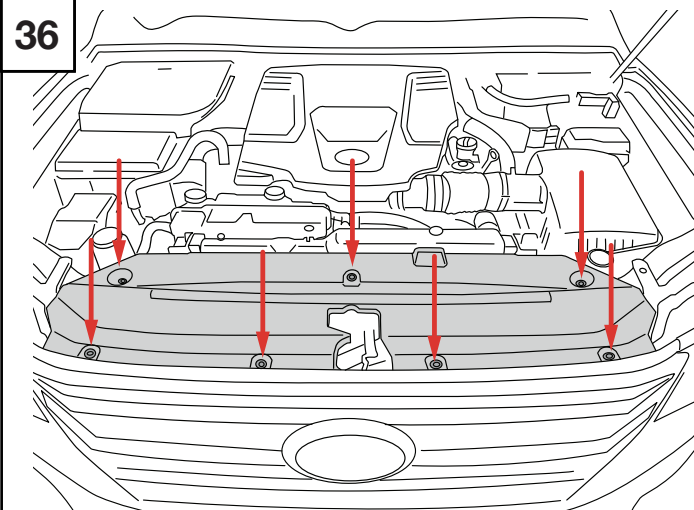

Wear eye protection when working beneath the vehicle as dirt and debris may be dislodged when removing bolts and under body panels.

**36****Remove the radiator support cover**

Remove the radiator support cover panel by removing the eight plastic clips.

Note: Clips disengage by pushing down on the centre button.

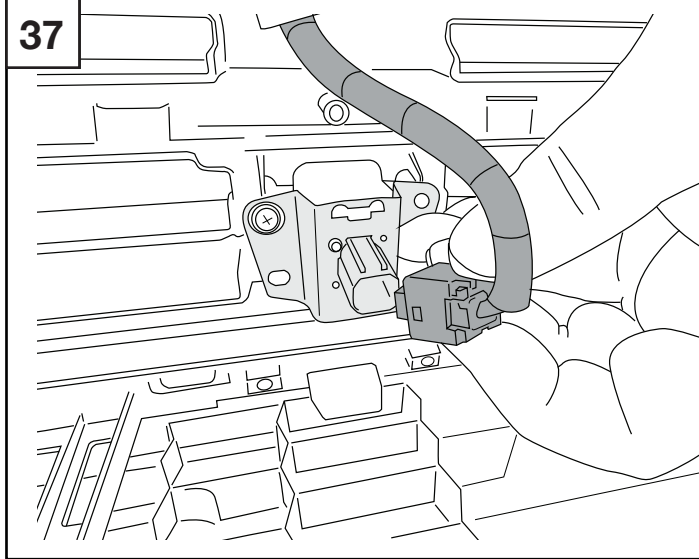
**37****Remove the front camera.**

Working behind the grille, disconnect the wiring harness from the back of the camera.

Remove the two Phillips head screws holding the camera and bracket to the grille.

Keep the screws for re-fitment in step 59.

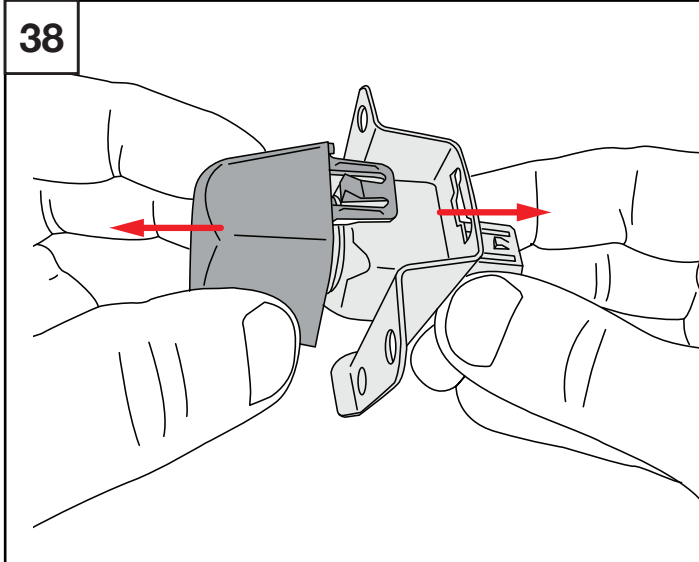
**38**

Remove the cover from the front of the camera by depressing the clips and pulling apart.

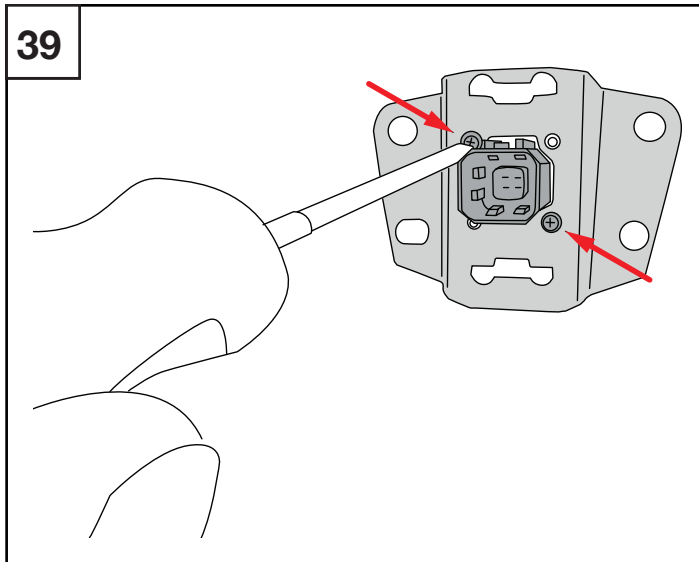
**39**

Remove the two Phillips head screws holding the camera to the bracket.

Keep the camera and screws aside for re-fitment in step 41.

## FITTING INSTRUCTIONS

NUDGE BAR TO SUIT  
**TOYOTA LC300**  
**SAHARA, VX, GX & GXL**

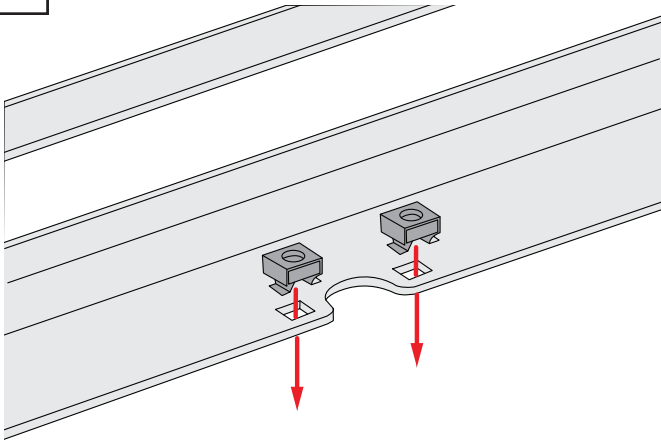
**40**

**Fit the camera to the nudge bar.**

Place two M6 cage nuts (P/No. 602-0003) into the square holes in the centre of the nudge bar .

Ensure the nuts are fitted to the inside.

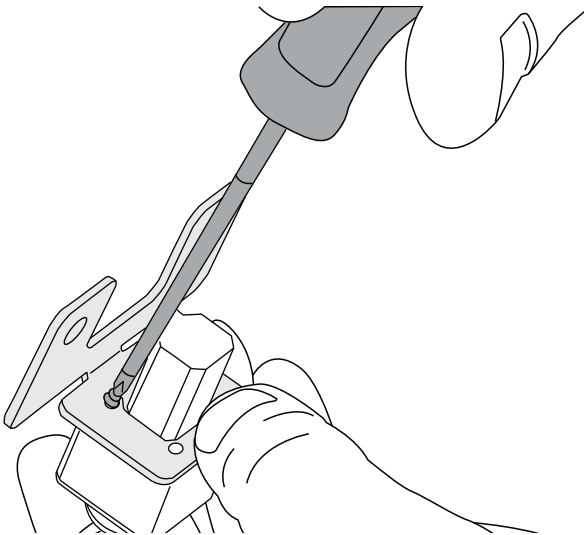
**41**

Refit the two Phillips head screws removed in Step 39.

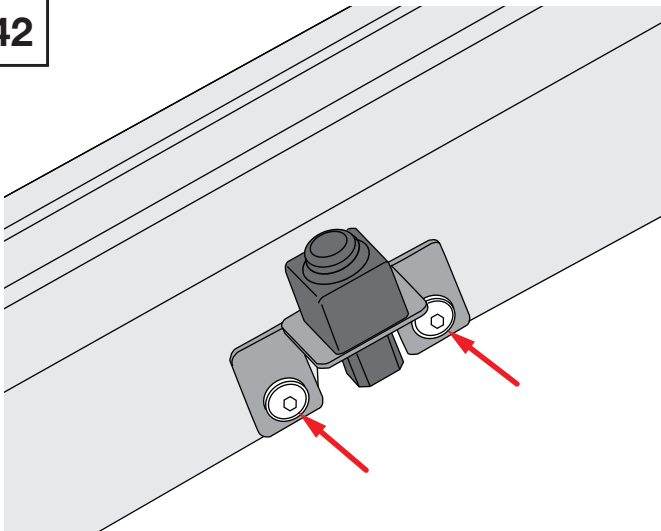
**42**

Mount the camera to the centre of the nudge bar using two M6 x 16 button head cap screws and flat washers.

Note: Leave screws loose until the next step.

## FITTING INSTRUCTIONS

NUDGE BAR TO SUIT  
**TOYOTA LC300**  
**SAHARA, VX, GX & GXL**

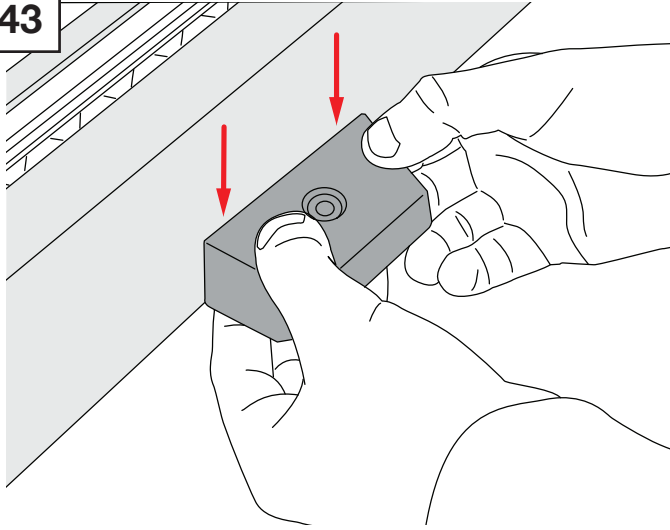
**43**

Fit the camera cover over the camera by sliding between the nudge bar and camera mount.



Torque: 9Nm (7lb/ft)

Note: ensure the screws are torqued sufficiently to crush the cage nuts.

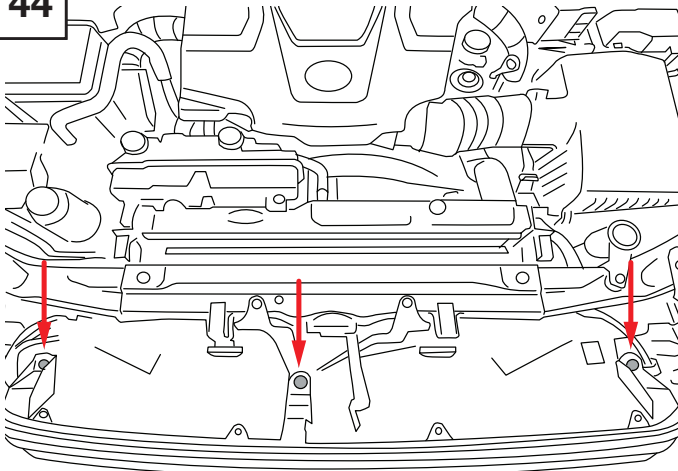
**44**

**Prepare for bumper removal.**

Remove the three M6 bolts attaching the top of the grille to the radiator support brackets.

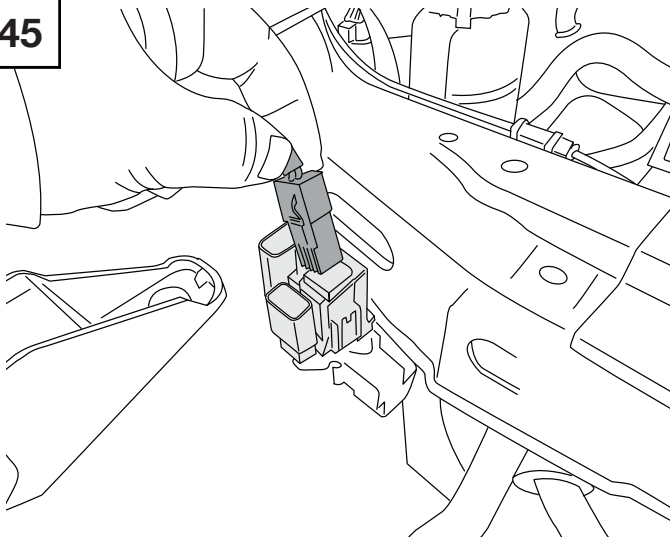
**45**

Disconnect the three plugs for the parking sensors, camera and radar located on the radiator support near the RHS headlamp.

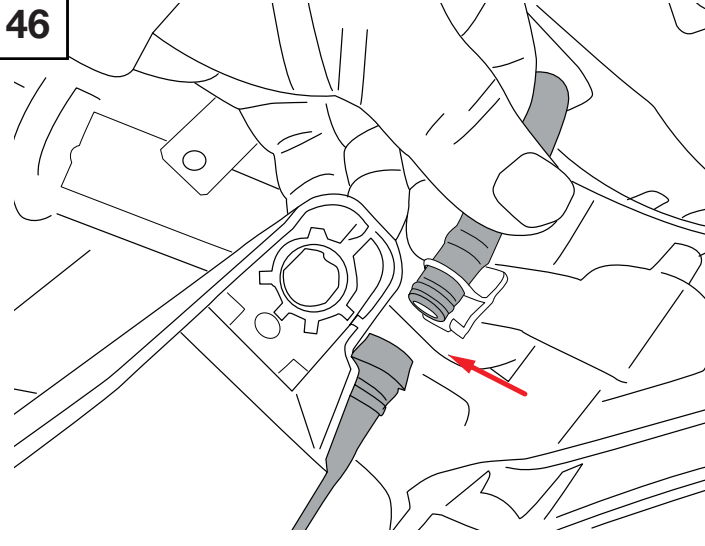
**46**

Disconnect the hose for the headlamp washers near the LHS headlamp behind the grille.

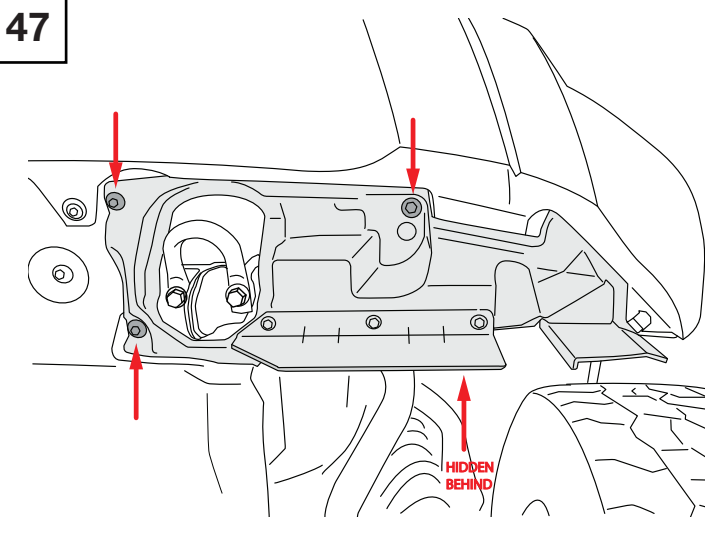
**47****Remove the wind deflector/spats**

Working from under the bumper, remove the three M6 bolts and 12mm nut as shown.

Place the spats aside for modification in step 72.

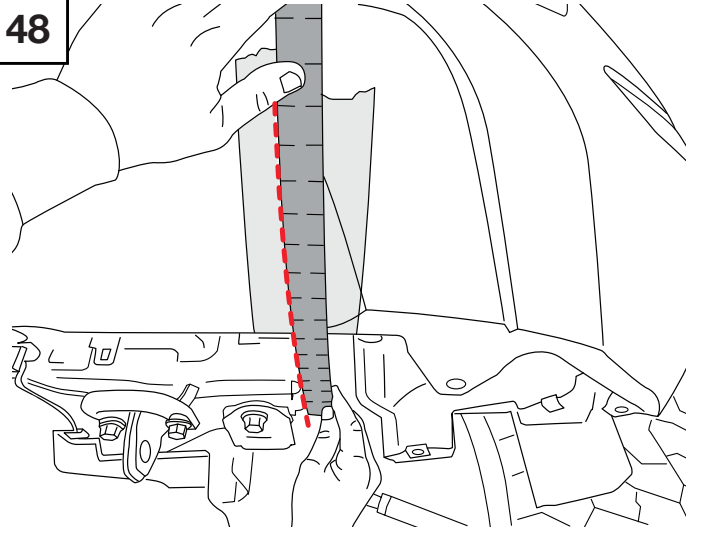
**48****Mark the bumper in preparation for cutting.**

Mask the bumper with masking tape covering the general area for cutting.

Using a steel rule or similar as a flexible straight edge, mark a reference line parallel to the chassis mounting point as shown.

## FITTING INSTRUCTIONS

NUDGE BAR TO SUIT

**TOYOTA LC300**

**SAHARA, VX, GX & GXL**

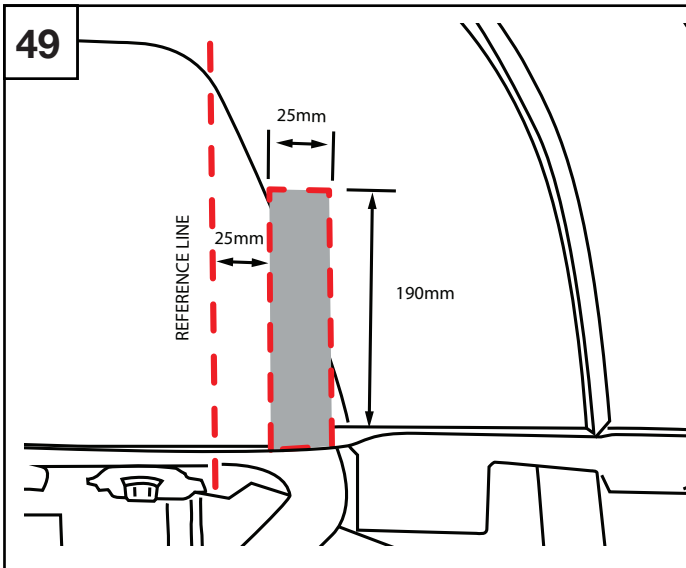

From the reference line, mark the area to be cut using the measurements as shown.

THE AREA SHADED IN GREY WILL BE CUT OUT.

Note: This area is covered by the nudge bar so does not need to be precise.

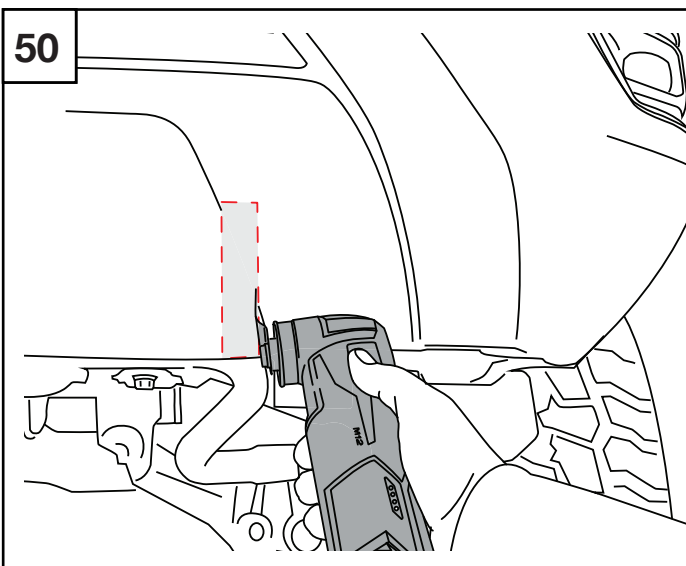

### Cutting the bumper.

Cutting the bumper can be achieved easily on the vehicle or can be done after the bumper is removed (to access the parking sensors).

Using a multi tool, carefully cut the section out of the bumper.

De-bur all edges with a file or blade.

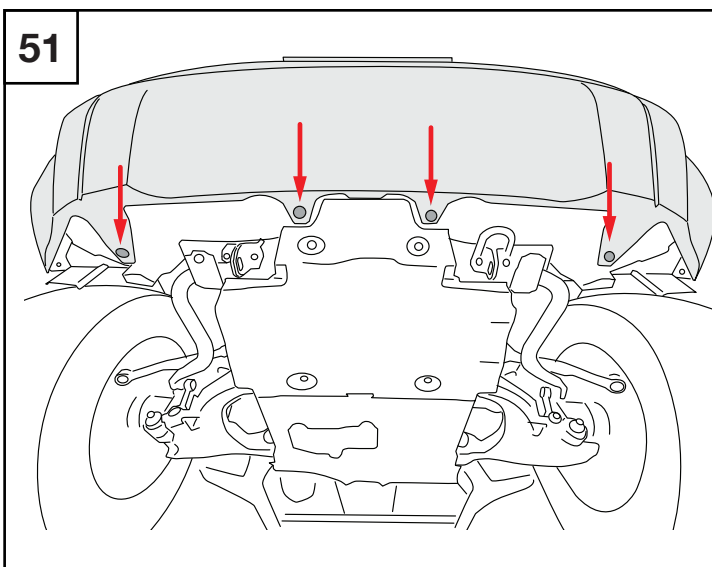

### Remove the bumper.

Removal of the bumper is required to easily access and disconnect the PDC (Park Distance Control) sensors and wiring.

Remove the four M6 bolts from the bottom of the bumper as shown.

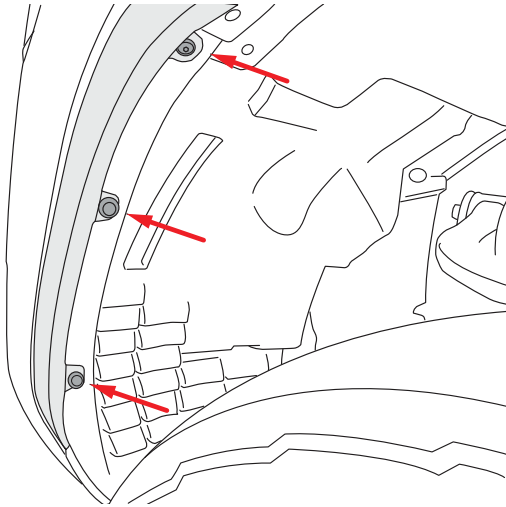
**52**

Remove the two clips and one torx screw holding the flare to the bumper assembly.



The clip centres can be popped out with a small screwdriver.

Use a T25 Torx bit for the Torx screw

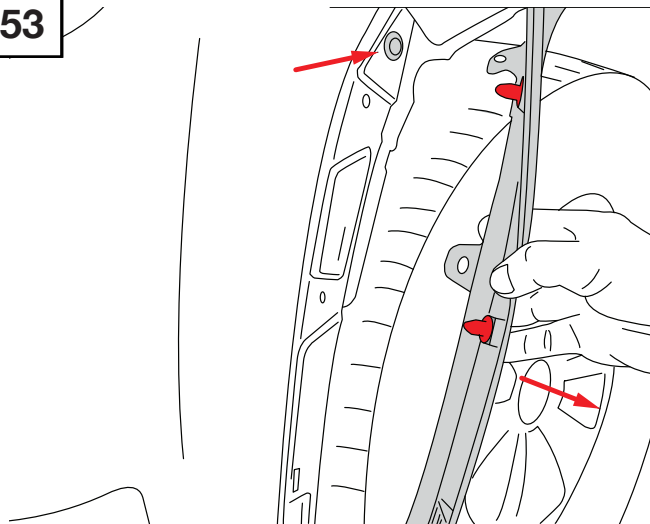
**53**

Working from the wheel arch edge, pull the flare away from the guard to detach the two red clips.

Behind where the flare sits is a clip that must be removed. (Shown with arrow)

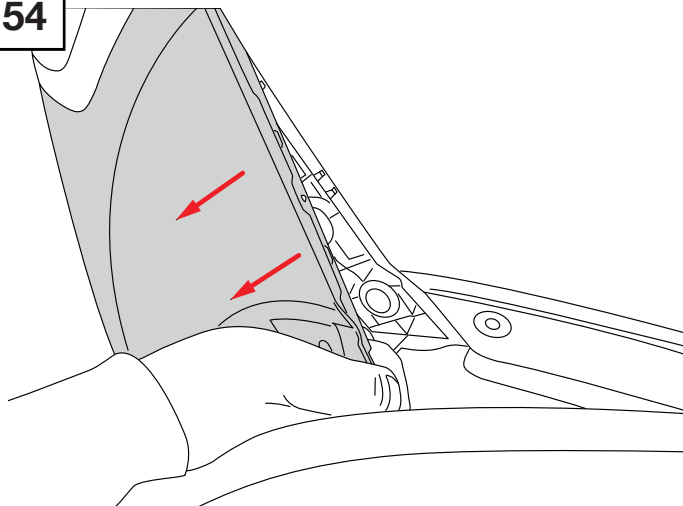
**54**

Working from the wheel arch edge, pull the bumper away from the guard to detach the clips. Initially this may require some force.

With one person on either side of the car, lift the bumper and grille assembly off and lay face down on a bench or stand.

Ensure something is used to protect the front of the bumper such as a blanket or similar.

## FITTING INSTRUCTIONS

NUDGE BAR TO SUIT

**TOYOTA LC300**

**SAHARA, VX, GX & GXL**

**55**

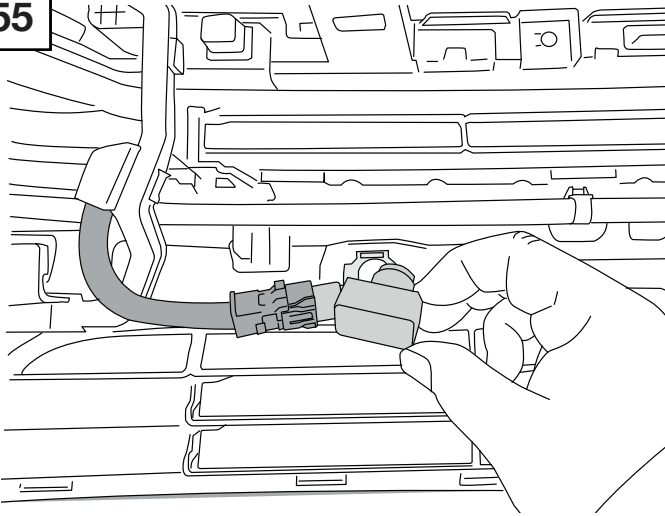

### Remove the PDC sensors.

Locate the two centre PDC sensors and remove them from the housings by releasing the clips.

Disconnect the wiring harness from the sensors and make note of the position (LH or RH) and orientation of the sensors so that they can be fitted to the nudge bar in the same positions.

NOTE: From the outside of the bumper, fit the two 18mm plastic hole plugs into the holes where the sensors were removed. (Not shown, refer part number 500-0003 in parts drawing).

**56**

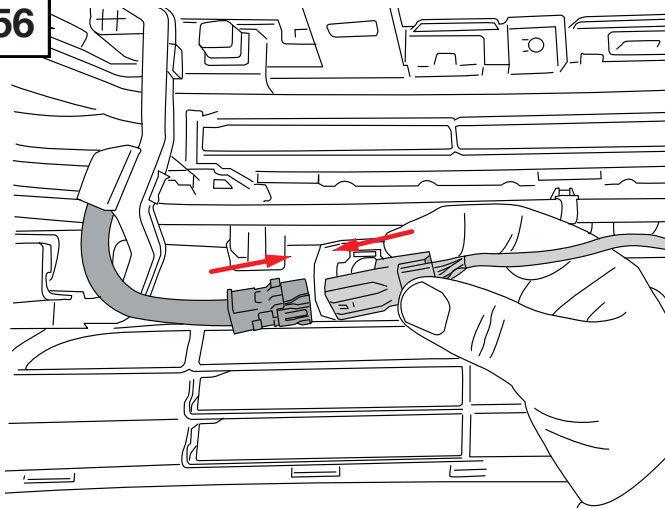

### Attach the PDC extension harness.

Connect the two PDC extension harnesses to the original harness plugs. Allow the cables to hang loosely. They will be cable tied when the bumper is refitted.

**57**

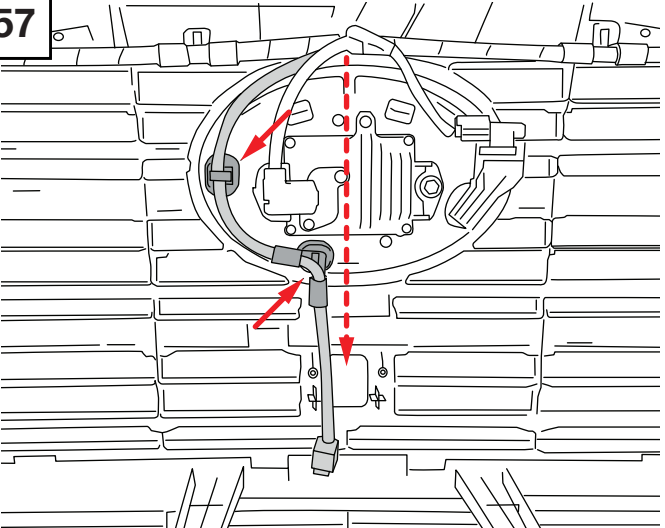

### Re-route the camera harness.

Behind the grille, remove the two cable ties that route the camera harness around the back of the logo.

Allow the cable to hang vertically as shown by the dotted line.

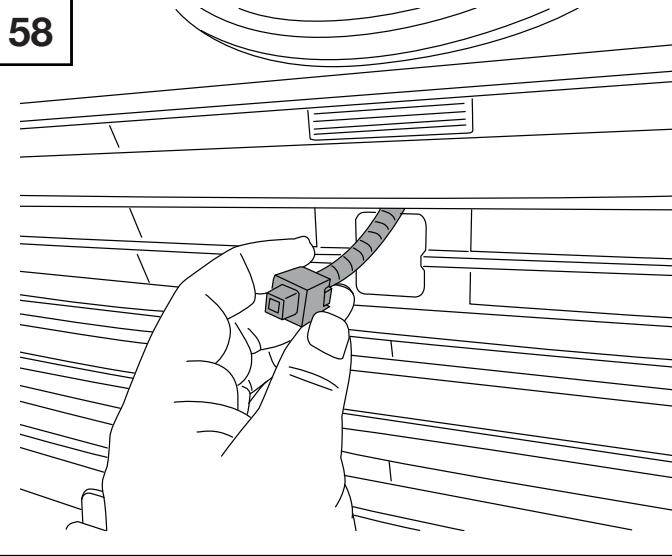
**58**

Pass the camera harness through the grille so that the elbow sits through the square opening.

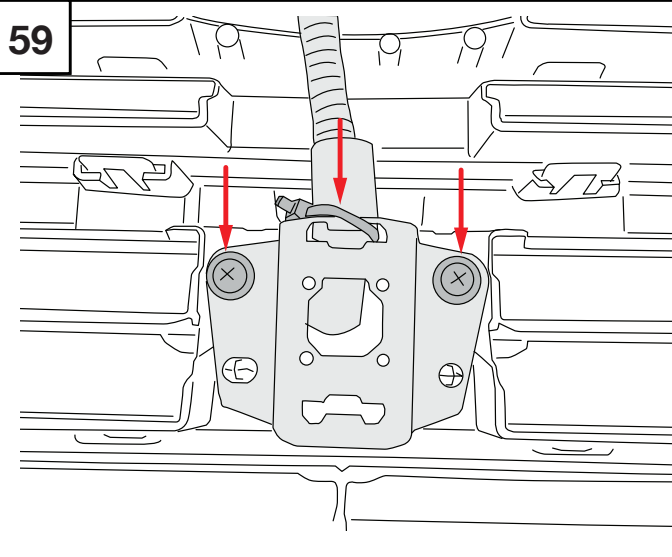
**59**

Refit the original camera bracket with Phillips head screws and cable tie the harness to the bracket to prevent rubbing as shown.

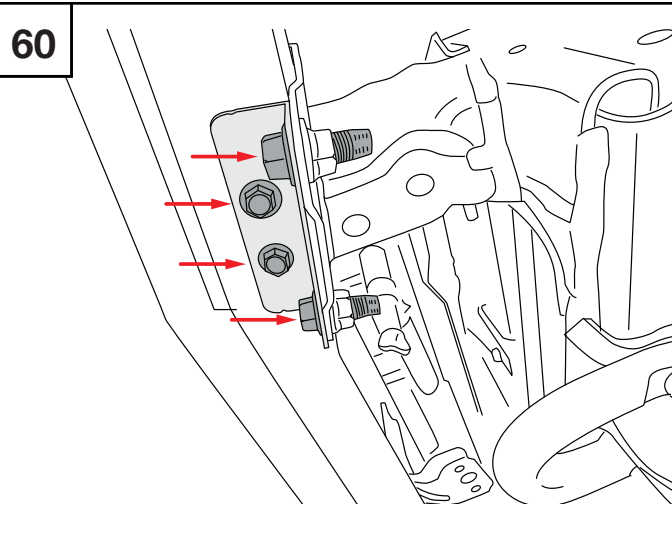
**60**

Working under the vehicle, remove the four M12 bolts and angled bracket that is attached to the end of the chassis rail and crash beam.

Note: LHS shown RHS similar.

Note: The brackets are not reused so may be discarded.

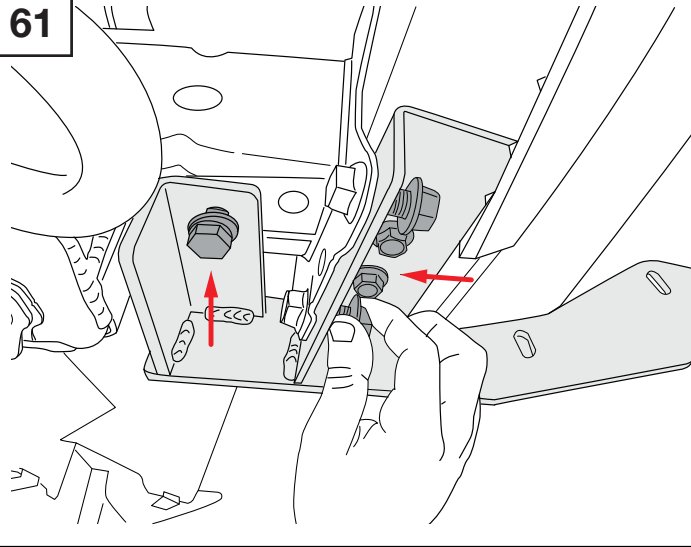
**61****Fit the chassis mount brackets.**

Hold the chassis bracket in place and reaching through the cutout in the bumper, refit the M12 bolts as shown.

Note: Do not tighten until step 68.

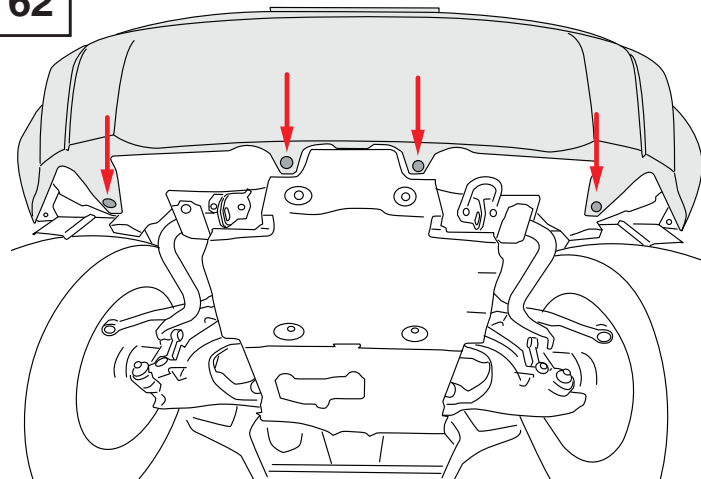
**62****Refit the bumper.**

Refit the bumper to the vehicle taking care as it fits over the nudge bar mounts.

Fitting is the reverse of steps 51-54.

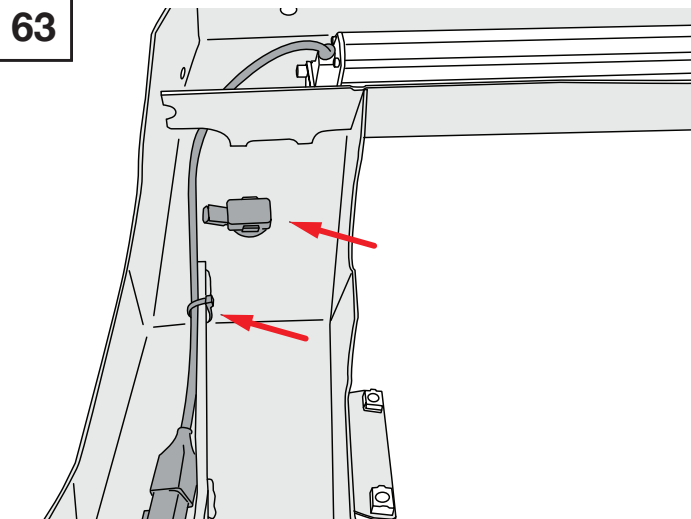
**63****Fit the PDC sensors to the nudge bar.**

Fit the PDC sensors into the sensor holders in the nudge bar, ensuring the electrical connectors face outwards as shown .

## FITTING INSTRUCTIONS

NUDGE BAR TO SUIT

TOYOTA LC300

SAHARA, VX, GX & GXL

64

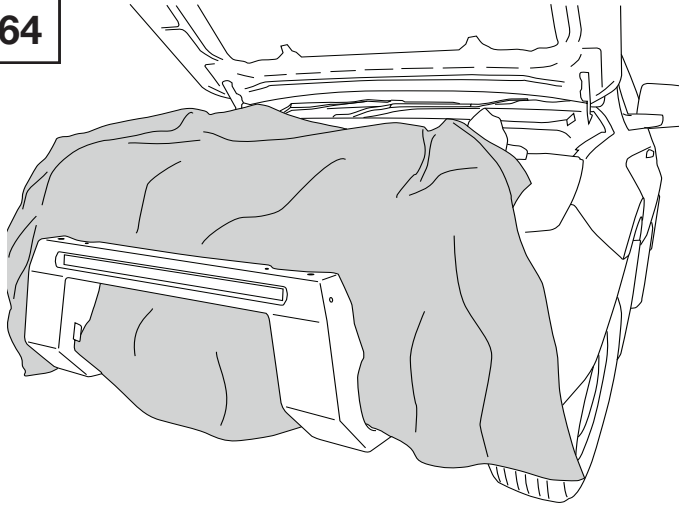

**Mounting the nudge bar.**



**Note:** This stage requires 2 or more people or a lifting device to lift & hold the nudge bar whilst it is bolted in place.

**Warning:** Due to close proximity of bar fitment to the vehicle, care should be taken not to scratch or dent the body. Use protective tape, rags or a blanket to protect areas of possible contact as shown.

65

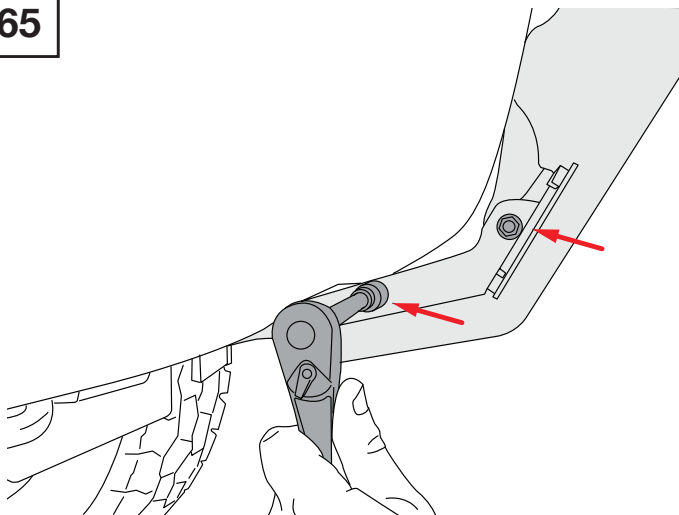

Lift the nudge bar into place. Install four M10 x 40 bolts, flat washers and Nyloc nuts to hold the nudge bar to the mounts as shown (two per mount). Do not torque at this stage.

**Note:** LHS shown, RHS same

**Note:** Bolt threads should be facing inward as shown in the diagram.

Once in place, the nudge bar can be allowed to rest loosely on the mounts and protective tape/rags/blanket used in previous step can be removed.

66

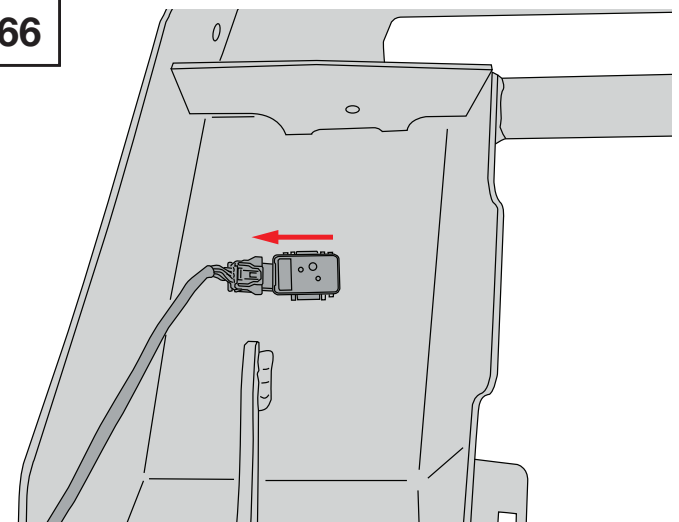

Fit the PDC extension harnesses to the sensors.

With the nudge bar leaning forward from the bumper, route the PDC sensor extension harnesses along the nudge bar mounts and up to the back of the sensors.

At this time the light bar can also be connected to the relay harness. Route the driving light fly lead along the LHS nudge bar mount and up to the LED light bar fly lead connector.

Cable tie both harnesses to the mount in the slots provided.

## FITTING INSTRUCTIONS

NUDGE BAR TO SUIT

**TOYOTA LC300**

**SAHARA, VX, GX & GXL**

**67**

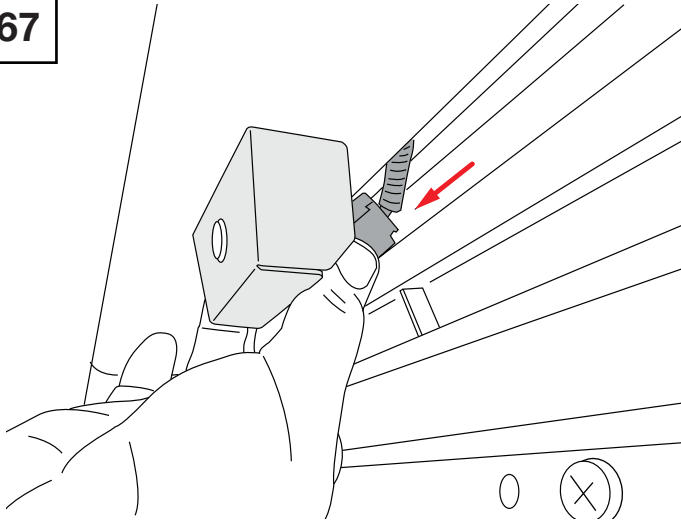

**Connect the camera wiring.**

Pull the nudge bar slightly forward and pass the camera harness through the hole in the nudge bar.

Connect it to the camera as shown.

**68**

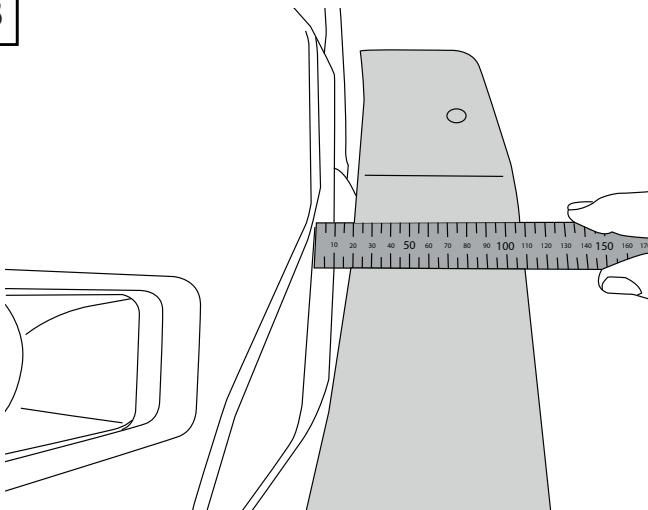

Adjust the nudge bar so that there is an even gap of approximately 20mm between the nudge bar and the vehicle bumper.

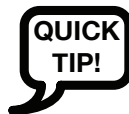

**Note:** Adjust the gap at the bottom of the bar by sliding in or out then tighten the rear bolts. The top of the bar can then be tilted in or out to achieve an even gap.



Tighten mounting bracket M10 bolts to 44Nm/16lb/ft

**69**

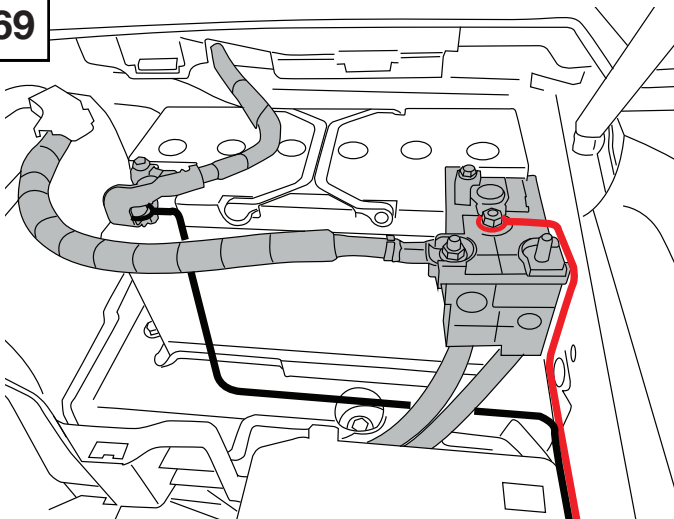

**Connect the positive and negative cables.**

Connect the positive (red) wire from the relay to the battery positive terminal.

Connect the negative (black) wire to the battery negative terminal. Ensure cables are secured with cable ties to prevent wear.

## FITTING INSTRUCTIONS

NUDGE BAR TO SUIT

**TOYOTA LC300**

**SAHARA, VX, GX & GXL**

**70**

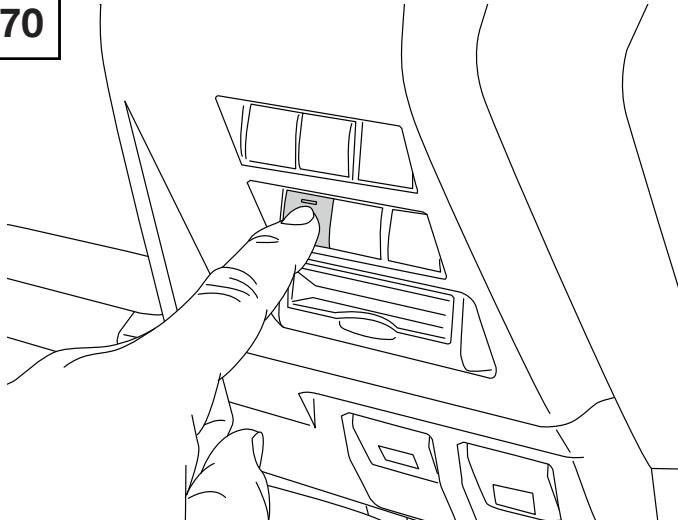

### Test the operation of the light bar.

Turn the vehicle ignition on and switch on the headlights. Check headlights for correct operation of high and low beam.

With the headlamps on high beam, depress the driving light switch. Check that the switch illuminates and that the light bar turns on. Toggle the headlamps between high and low beam to check driving light switches on and off with high beam.

**71**

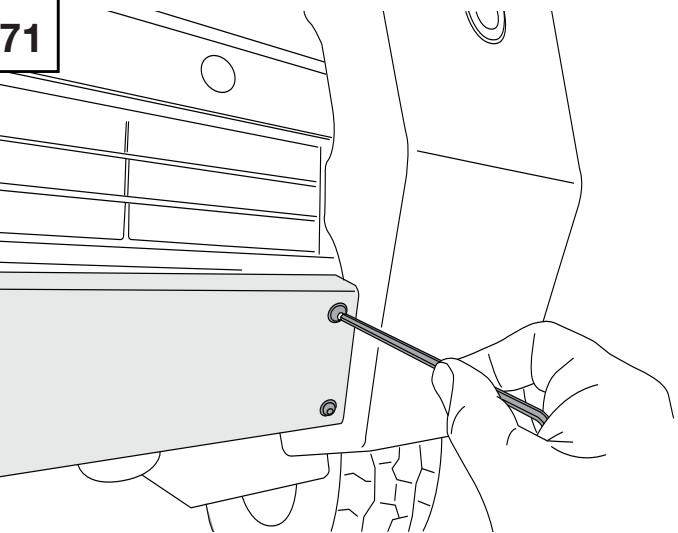

### Install the centre pan.

Using four M6 x 16 stainless steel cap screws and flat washers, install the centre pan as shown.



Note: Ensure the screws are done up tight to allow the cage nut to compress.

Torque: 9Nm (7lb/ft)

Alternatively use thread locking compound such as Loctite 243.

**72**

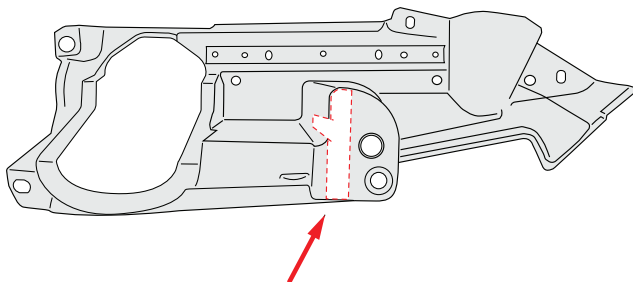

### Modify the outer wind deflector/spat panels.

The wind deflector panels require modification to allow refitting after fitment of the nudge bar.



Using the measurements in the next step as a guide, mark the area to be cut out with a marker or paint pen.

**FITTING INSTRUCTIONS**

NUDGE BAR TO SUIT  
**TOYOTA LC300**  
**SAHARA, VX, GX & GXL**

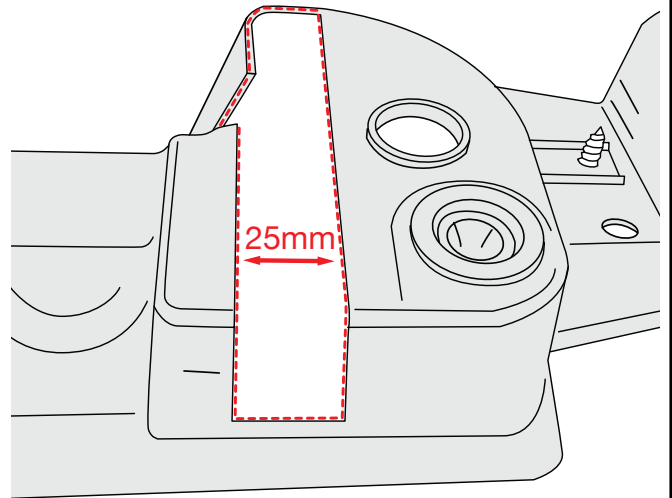
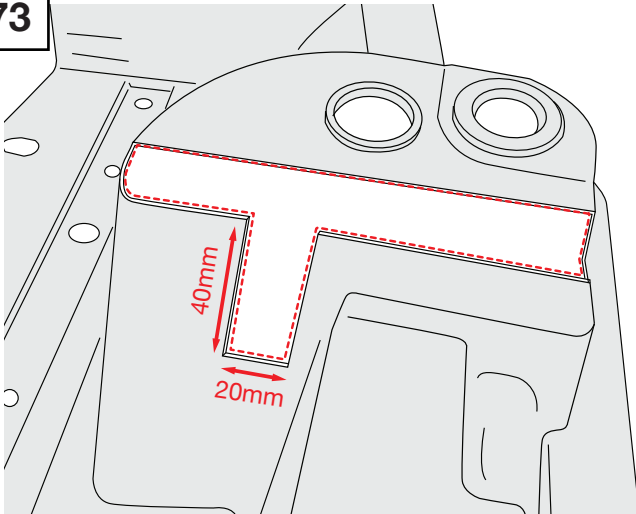
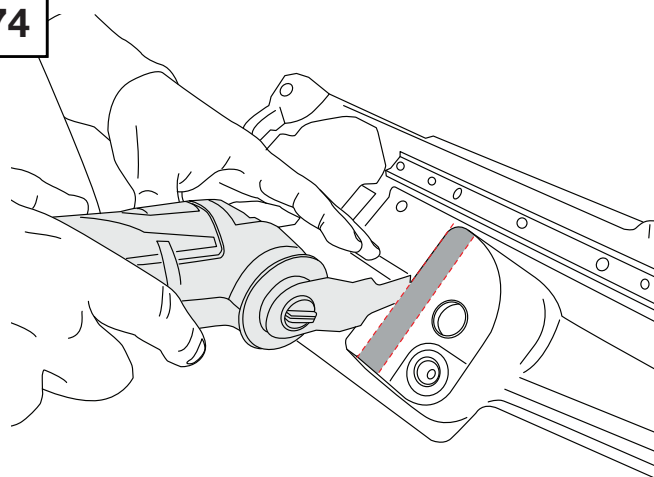
**73**

**74**

Trim the plastic as marked using a multitool. Use measurements above as a reference. Discard the excess material (shown here in grey).

Using a file or sand paper, remove any sharp edges to prevent injury.

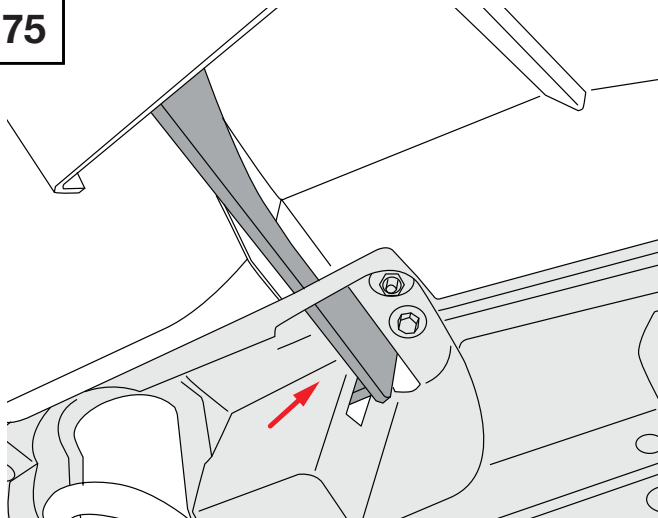
Note: LHS shown, RHS same.

**75**

**Refit the wind deflector/spat panels.**

Working from under the vehicle, fit the wind deflector/spat panel over the nudge bar mount as shown.

Refit using the original screws and nut removed in step 47.

Note: If the panel interferes with the mount, remove more material as required.

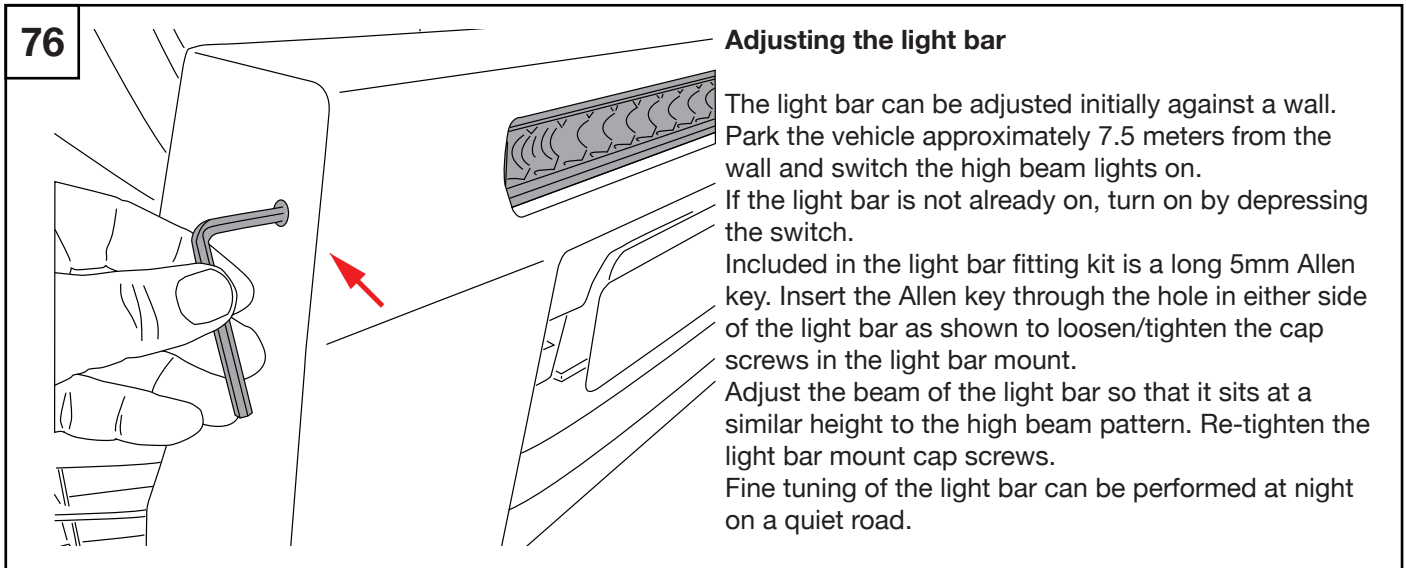

## WARRANTY

Ultimate9 provides to the original purchaser, a 12 month warranty against manufacturing faults or defects. Conditions resulting from normal wear & tear, modification, misuse, abuse or incorrect fitment are not covered and will void the warranty.

In order to make a claim under this warranty, the purchaser must:

- Return the product to the place of purchase with a valid receipt/invoice or proof of purchase or contact Ultimate9 customer service on 03 9729 8515.
- Provide Ultimate9 with any additional information as requested.

The purchaser is responsible for any return freight or fitting/removal costs incurred when making a claim under this warranty unless communicated otherwise by Ultimate9.

This warranty is limited to the original purchaser and is not transferable.

*Our goods come with guarantees that cannot be excluded under the Australian Consumer Law. You are entitled to a replacement or refund for a major failure and compensation for any other reasonably foreseeable loss or damage. You are also entitled to have the goods repaired or replaced if the goods fail to be of acceptable quality and the failure does not amount to a major failure.*

HEAD OFFICE	POSTAL ADDRESS	DELIVERY ADDRESS	CONTACT
Ultimate9	Factory A/28a Kalman Drive, Boronia VIC, 3155	Factory A/28a Kalman Drive, Boronia VIC, 3155	T +61 3 9729 8515 E sales@ultimate9.co W www.ultimate9.co